

SECTION 5 PARTS LIST

SAFETY PRECAUTION

Parts identified by the \triangle symbol are critical for safety. Replace only with specified part numbers.

5.1 PACKING AND ACCESSORY ASSEMBLY <M1>

The instruction manual to be provided with this product will differ according to the destination.

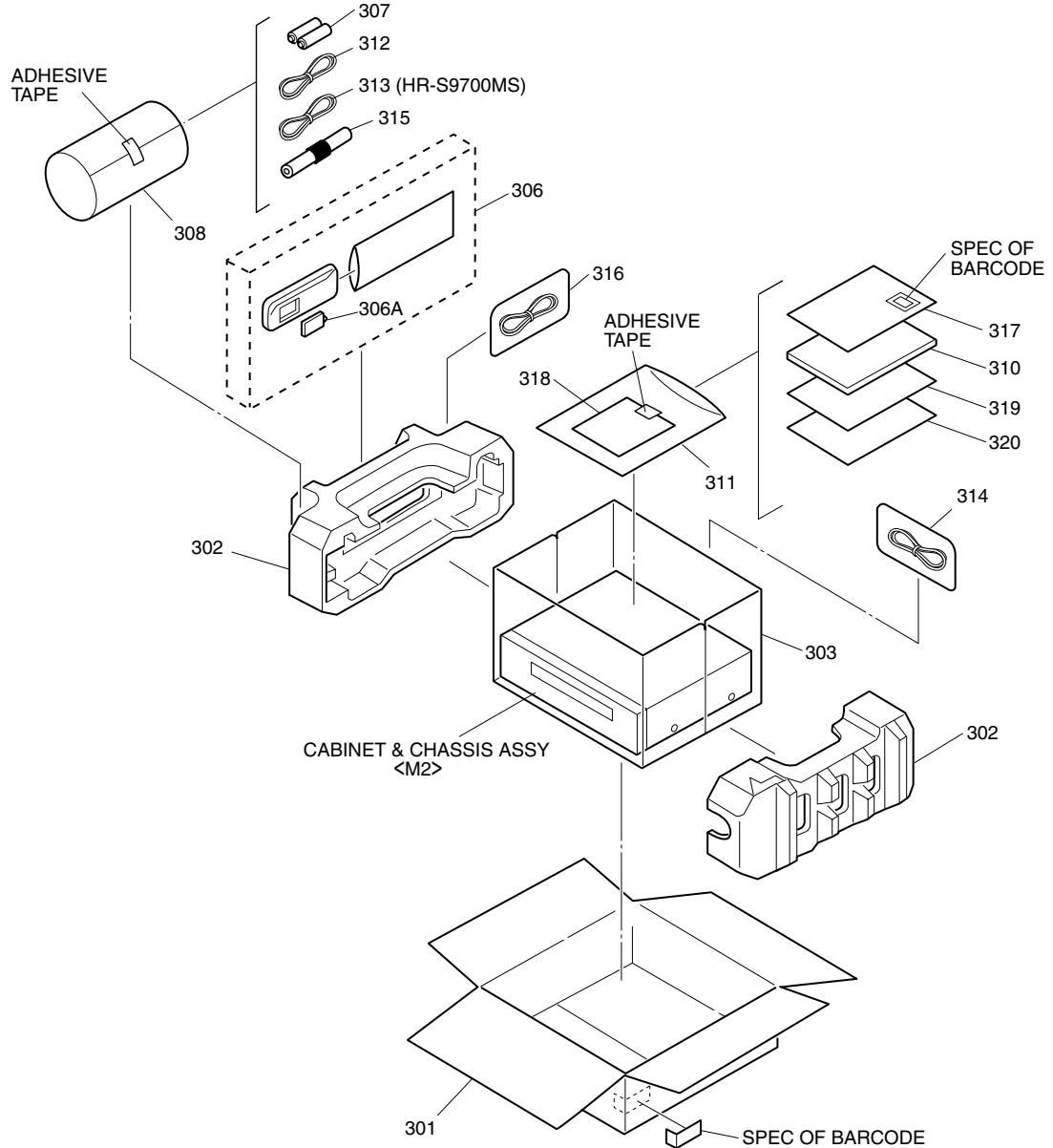

\triangle REF No. PART No. PART NAME, DESCRIPTION

PACKING AND ACCESSORY ASSEMBLY <M1>

301	LP30714-001B	PACKING CASE,S8700MS
	LP30715-001B	PACKING CASE,S9700MS
302	LP30606-002C	CUSHION ASSY,S8700MS
	LP30667-001C	CUSHION ASSY,S9700MS
303	PQM30021-95	POLY BAG
306	LP20667-008B	REMOTE CONTROLLER
306A	LP40225-002A	COVER(BATTERY)
307	-	BATTERY,X2("R6"TYPE)
308	QPC02202230P	POLY BAG

\triangle REF No. PART No. PART NAME, DESCRIPTION

\triangle	310	LPT0335-001A	INST BOOK(FR),S8700MS
\triangle		LPT0336-001B	INST BOOK(FR),S9700MS
	311	QPC02503530P	POLY BAG
	312	PEAC0300-02	RF CABLE
	313	PEAC0358-120	S CABLE,S9700MS
	314	QAL0095-005	LED CABLE ASSY(Satellite Controller)
	315	PEAC0429	P/S CONV PLUG
	316	QAM0020-001	PERI CABLE
	317	BT-54008-2	GUARANTY CARD
	318	LPT0002-0F6B	SHEET(ATTENTION)
	319	LP40437-001A	LABEL(S-VHS ET)
	320	LP40605-001A	SHEET

5.2 CABINET AND CHASSIS ASSEMBLY <M2>

BEWARE OF BOGUS PARTS

Parts that do not meet specifications may cause trouble in regard to safety and performance. We recommend that genuine JVC parts be used.

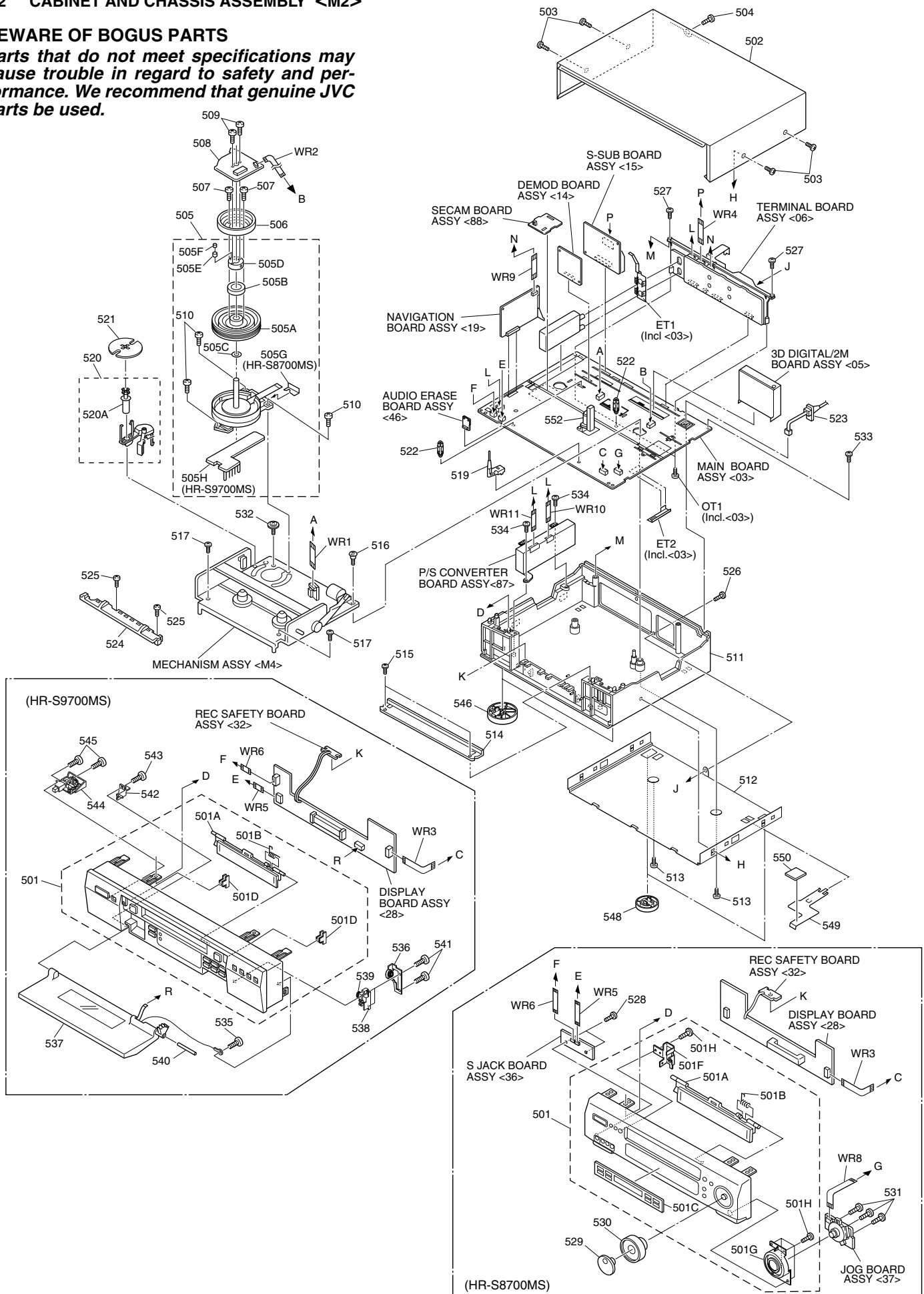

#	△	REF No.	PART No.	PART NAME, DESCRIPTION	#	△	REF No.	PART No.	PART NAME, DESCRIPTION

CABINET AND CHASSIS ASSEMBLY <M2>									
△		501	LP10236-007C	FRONT PANEL ASSY,S9700MS			536	LP40582-002A	DAMPER ASSY,S9700MS
△			LP10088-020D	FRONT PANEL ASSY,S8700MS			537	LP20702-004A	MEMBRANE DOOR,S9700MS
		501A	LP20661-003A	CASSETTE DOOR,S9700MS			538	LP30570-001A	HOLDER(DAMPER),S9700MS
			LP20716-007A	CASSETTE DOOR,S8700MS			539	QZW0012-002	DAMPER,S9700MS
		501B	PQ46448	TORSION SPRING			540	LP40500-001A	SHAFT,S9700MS
		501C	LP20250-013B	DISPLAY WINDOW,S8700MS			541	QYTDSF3010Z	SCREW,X2,S9700MS
		501D	PEME0879	MAGNET ASSY,X2,S9700MS			542	LP40501-001A	HOLDER(DOOR),S9700MS
		501F	LP40159-001B	BRACKET(DAMPER),S8700MS			543	QYTDSF3010Z	SCREW,S9700MS
		501G	LP20613-004A	ORNAMENT,S8700MS			544	QZW0031-002	DOOR OPEN UNIT,S9700MS
		501H	SDSF2608Z	SCREW,X5,S8700MS			545	QYTDSF3010Z	SCREW,X2,S9700MS
△		502	PQ11922-34	TOP COVER			546	PQ46617A-1	FOOT ASSY,X2,S9700MS
		503	QYTDSF3010R	SCREW,X4 TOP COVER(SIDE)			548	PQ35504-2	FOOT(2),X2,S9700MS
		504	QYTDSF3010M	SCREW, TOP COVER(REAR)			549	LP40659-001A	EARTH PLATE(2)
		505	LP20319-021A	DRUM SUB ASSY,S9700MS			550	LP30002-092A	SPACER
			LP20617-016A	DRUM SUB ASSY,S8700MS			552	LP40253-001B	STOPPER
		505A	LP20030-022A	UPPER DRUM ASSY,S9700MS			WR1	QUQ112-0720CG	FFC WIRE,A/C HEAD CN2001
			LP20030-023A	UPPER DRUM ASSY,S8700MS			WR2	QUQ212-0518CG	FFC WIRE,DRUM CN3001
		505B	LP40543-001A	CAP			WR3	QUQ112-1414CG	FFC WIRE,DISPLAY CN3011
		505C	PDM4444-19-2	WASHER			WR4	QUQ112-1407CG	FFC WIRE,TERMINAL CN512
		505D	LP40572-001A	COLLAR ASSY			WR5	QUQ212-0516CG	FFC WIRE,JACK CN902
		505E	LP40323-001A	CONTACT			WR6	QUQ212-0416CG	FFC WIRE,S(FSA) CN901
		505F	LP30004-014A	COMPRESION SPRING			WR8	QUQ112-0616CG	FFC WIRE,JOG CN3012 S8700MS
		505G	LP40174-001B	FPC PLATE,S8700MS			WR9	QUQ112-0826CG	FFC WIRE,NAVIGATION CN912
		505H	LPA20002-01C	SENSOR BOARD ASSY,S9700MS			WR10	QUQ112-0922CG	FFC WIRE,S/P CONVERTER CN513
		506	PDZ0179-1-4	ROTOR ASSY,S8700MS			WR11	QUQ212-0414CG	FFC WIRE,S/P CONVERTER CN1901 S8700MS
			PDZ0179-2-4	ROTOR ASSY,S9700MS				QUQ112-1014CG	FFC WIRE,P/S CONVERTER CN1901 S9700MS
		507	QYSPSP3006Z	SCREW,X2					
△		508	QAR0119-001	STATOR ASSY					
		509	QYSPSPH2606Z	SCREW,X2					
		510	QYTDST2610Z	SCREW,X3 DRUM					
△		511	LP10140-003G	BOTTOM CHASSIS,S9700MS					
△			LP10140-006F	BOTTOM CHASSIS,S8700MS					
△		512	PQ11921-1-4	BOTTOM COVER					
		513	QYTDSF3010Z	SCREW,X2					
		514	LP30312-001B	BRACKET(CHASSIS)					
		515	QYTDSF3010Z	SCREW,X2					
		516	LP40700-001A	SPECIAL SCREW,MECHA					
		517	QYTDSF3010Z	SCREW,X2 MECHA					
		519	LP40407-001A	KNOB ASSY					
		520	LP40370-001E	ROLLER ARM ASSY					
		520A	PDM4311A-1	ROLLER ASSY					
		521	PQ45160	INERTIA PLATE					
		522	LP40226-001A	PC SUPPORT,X2					
△		523	QMP4A10-170	POWER CORD					
		524	LP30247-001C	FRONT BRACKET					
		525	QYTDST2606Z	SCREW,X2					
		526	QYTDSF3010M	SCREW,TERMINAL					
		527	QYTSPFG3010Z	SCREW,X2 TERMINAL					
		528	QYTDSF2608Z	SCREW,X2 S JACK,S8700MS					
		529	LP30694-001A	KNOB(JOG),S8700MS					
		530	LP30695-001A	KNOB(SHUTTLE),S8700MS					
		531	QYTDSF2608Z	SCREW,X3 JOG,S8700MS					
		532	PQ40413	SPECIAL SCREW,MECHA					
		533	QYTDSF3010Z	SCREW,MAIN					
		534	QYTDSF3010Z	SCREW,X2 P/S CONVERTER					
		535	QYTDSF3010Z	SCREW,EARTH PLATE,S9700MS					

5.3 MECHANISM ASSEMBLY <M4>

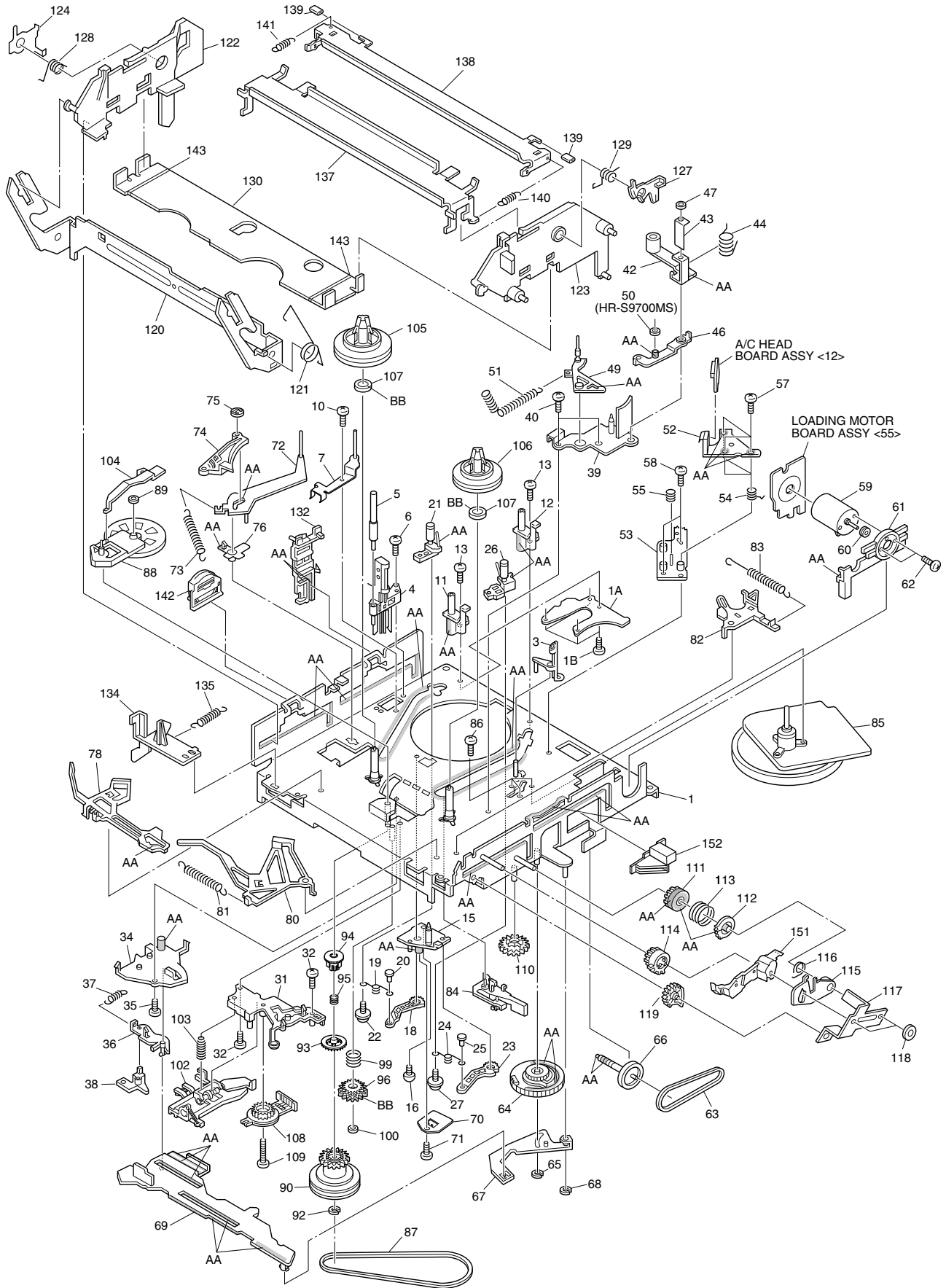

Classification	Part No.	Symbol in drawing
Grease	KYODO-SH-P	AA
Oil	COSMO-HV56	BB

NOTE:The section marked in **AA** and **BB** indicate lubrication and greasing areas.

#	△ REF No.	PART No.	PART NAME, DESCRIPTION

MECHANISM ASSEMBLY <M4>			
1		LP20821-002F	MAIN DECK ASSY,S8700MS
		LP20884-002F	MAIN DECK ASSY,S9700MS
1A		LP40275-004B	PLATE(SUPPLY),S8700MS
		LP40275-002B	PLATE(SUPPLY),S9700MS
1B		QYTDST2605Z	SCREW,X4,S8700MS
		QYTDST2606Z	SCREW,X4,S9700MS
3		LP30492-002B	GUIDE POOL GUARD
4		NAH0001-001	FULL ERASE HEAD
5		LP40098-001B	GUIDE POLE(SUPPLY)
6		QYTDST2608Z	SCREW
7		LP40637-002A	TENSION STUD BASE ASSY
10		QYTDST2606Z	SCREW
11		LP30409-002C	UV CATCHER 2
12		LP30409-002C	UV CATCHER 2
13		QYTPST2606Z	SCREW,X2
15		LP30223-003C	LOADING ARM GEAR SHAFT
16		QYTDST2606Z	SCREW
18		LP30224-001A	LOADING ARM GEAR(SUPPLY)
19		LP40099-001A	TORSION ARM
20		LP40100-001A	PIN
21		LP40101-006A	POLE BASE ASSY(SUPPLY),S8700MS
		LP40101-007A	POLE BASE ASSY(SUPPLY),S9700MS
22		QYSPSTG2606Z	SCREW
23		LP40103-002B	LOADING ARM GEAR(TAKE UP)
24		LP40099-001A	TORSION ARM
25		LP40100-001A	PIN
26		LP40104-006A	POLE BASE ASSY(TAKE UP),S8700MS
		LP40104-008A	POLE BASE ASSY(TAKE UP),S9700MS
27		QYSPSTG2606Z	SCREW
31		LP20233-004B	ROTARY ENCODER GUIDE
32		QYTPST2606Z	SCREW
34		LP30226-004D	CONTROL PLATE GUIDE
35		QYTPST2605Z	SCREW
36		LP30249-003B	TAKE UP LEVER
37		LP30003-006A	TENSION SPRING
38		LP40119-002A	TAKE UP HEAD
39		LP20234-004B	LID GUIDE
40		QYTDST2606Z	SCREW,X2
42		LP40105-001B	PINCH ROLLER ARM ASSY
43		LP40478-001A	PINCH ROLLER SHEET2
44		LP40148-002A	TORSION SPRING
46		LP40149-001C	PRESS LEVER ASSY
47		LP30016-002A	SLIT WASHER
49		LP40106-007A	GUIDE ARM ASSY,S8700MS
		LP40106-002E	GUIDE ARM ASSY,S9700MS
50		LP30017-008A	SPACER,S9700MS
51		LP40134-001C	TENSION SPRING
52		QAH0010-004	AC HEAD
53		LP30228-001A	HEAD BASE
54		LP30004-013A	COMPRESSION SPRING,X3
55		LP40236-001A	COMPRESSION SPRING
57		LP40213-002B	SPECIAL SCREW,X3
58		QYTDST2608Z	SCREW,X2
59		QAR0023-001	LOADING MOTOR
60		PQ43546-1-2	MOTOR PULLEY
61		LP30230-001B	MOTOR GUIDE
62		QYTPSP3003Z	SCREW,X2
63		LP30005-003A	BELT,LOADING MOTOR
64		LP20791-002D	CONTROL CAM
65		PQM30017-24	SLIT WASHER
66		LP40120-001A	WORM GEAR
67		LP40107-002A	LINK LEVER ASSY
68		PQM30017-24	SLIT WASHER
69		LP10284-002E	CONTROL PLATE

#	△ REF No.	PART No.	PART NAME, DESCRIPTION
70		LP40379-001B	CONTROL BRACKET(1)
71		QYTDST2608M	SCREW
72		LP40108-002A	TENSION ARM ASSY
73		LP30003-010A	TENSION SPRING
74		LP40109-003D	TENSION BRAKE ASSY
75		PQ46302-1-3	ADJUST PIN
76		LP30232-002A	TENSION ARM BEARING
78		LP40532-009A	MAIN BRAKE ASSY (SUPPLY),S8700MS
		LP40532-009B	MAIN BRAKE ASSY (SUPPLY),S9700MS
80		LP40111-014A	MAIN BRAKE ASSY (TAKE UP),S8700MS
		LP40111-014B	MAIN BRAKE ASSY (TAKE UP),S9700MS
81		LP30003-029A	TENSION SPRING
82		LP40112-001F	SUB BRAKE ASSY(TAKE UP)
83		LP40357-001B	TENSION SPRING
84		LP40461-001A	CAPSTAN BRAKE ASSY
85		QAR0132-001	CAPSTAN MOTOR
86		QYTDST2606M	SCREW,X3
87		LP30005-008A	BELT,CAPSTAN MOTOR
88		LP40114-011B	IDLER ARM ASSY
89		LP30016-001A	SLIT WASHER
90		LP40593-003B	CLUTCH UNIT 3
92		PQM30017-47	SLIT WASHER
93		LP30696-002A	CLUTCH GEAR 4
94		LP30697-003A	COUPLING GEAR
95		LP40554-002A	COMPRESSION SPRING
96		LP40442-001A	DIRECT GEAR
99		LP40483-002A	COMPRESSION SPRING
100		LP30016-001A	SLIT WASHER
102		LP40484-003B	CHANGE LEVER ASSY
103		LP40512-002B	COMPRESSION SPRING
104		LP30236-002B	IDLER LEVER
105		LP20237-003B	REEL DISK ASSY(SUPPLY)
106		LP20238-003B	REEL DISK ASSY(TAKE UP)
107		LP30017-015A	SPACER,X2
108		QSW0554-003	ROTARY ENCODER
109		QYTPST2620Z	SCREW
110		LP30237-002B	CASSETTE GEAR
111		LP30239-002G	LIMIT GEAR(1)
112		LP30240-002G	LIMIT GEAR(2)
113		LP40136-001E	TORSION SPRING
114		LP30242-002A	RELAY GEAR
115		LP30339-002E	OPENER GUIDE
116		LP40545-001A	TORSION SPRING
117		LP40214-001B	C.H.BRACKET
118		PQM30017-47	SLIT WASHER,X2
119		LP30243-001D	DRIVE GEAR
120		LP20240-001G	DRIVE ARM
121		LP40137-001A	TORSION SPRING
122		LP10081-002L	SIDE HOLDER(L)
123		LP10082-002M	SIDE HOLDER(R)
124		LP30255-006A	LOCK LEVER(L)
127		LP30256-001H	LOCK LEVER(R)
128		LP40168-001A	TORSION SPRING(L),S9700MS
		LP40168-003A	TORSION SPRING(L),S8700MS
129		LP40218-001B	TORSION SPRING(R)
130		LP30257-001G	CASSETTE HOLDER
132		LP30244-002G	GUIDE RAIL
134		LP30245-002E	REC SAFETY LEVER
135		LP30003-004A	TENSION SPRING
137		LP20578-001C	TOP GUIDE
138		LP30500-001C	HOLD PLATE
139		LP40450-003A	PAD,X2
140		LP30003-025B	TENSION SPRING
141		LP30003-024A	TENSION SPRING
142		LP40481-003A	ROLLER CAM ASSY
143		LP30019-014A	PAD,X2
151		LP20324-003B	DOOR OPENER
152		LP30493-001B	START SENSOR CAP

5.4 ELECTRICAL PARTS LIST

#	△ REF No.	PART No.	PART NAME, DESCRIPTION

MAIN BOARD ASSEMBLY <03>			
PW1		LPA10106-17B1	MAIN BOARD ASSY,S9700MS
		LPA10106-18B1	MAIN BOARD ASSY,S8700MS
IC1		JCP8020-MSD-2	IC
IC2		MM1113XF	IC
IC2501		LC85405JE	IC,S9700MS
IC3001		HD6432194AA10F	IC(MCU)
IC3002		S-80727AN-DQ-X	IC
		or S-80827ANUP-W	IC
		or R3111H271A	IC
IC3003		AT24C16-10PC	IC
		or 24LC16B/P	IC
		or BR24C16	IC
IC3004		BA6956AN	IC
IC3501		BA6956AN	IC,S9700MS
IC3601		BU2090FS	IC
IC3651		BU2090FS	IC
IC5101		STR-G6551	IC
IC5301		LA5644	IC
IC6080		NJM2125F	IC
Q5		2SB1218A/QR/-X	TRANSISTOR
		or 2SA1576A/QR/-X	TRANSISTOR
		or 2PA1576/R/-X	TRANSISTOR
Q7		2SD1819A/QRS/-X	TRANSISTOR
		or 2PC4081/R/-X	TRANSISTOR
		or 2SC4081/QRS/-X	TRANSISTOR
Q8		2SD1819A/QRS/-X	TRANSISTOR
		or 2SC4081/QRS/-X	TRANSISTOR
		or 2PC4081/R/-X	TRANSISTOR
Q9		2SB1218A/QR/-X	TRANSISTOR
		or 2PA1576/R/-X	TRANSISTOR
		or 2SA1576A/QR/-X	TRANSISTOR
Q10		2SB1218A/QR/-X	TRANSISTOR
		or 2SA1576A/QR/-X	TRANSISTOR
		or 2PA1576/R/-X	TRANSISTOR
Q14		UN511E	TRANSISTOR
		or PDTA144WU	TRANSISTOR
		or RN2309	TRANSISTOR
		or DTA144WU	TRANSISTOR
Q17		DTC144WU	TRANSISTOR
		or PDTC144WU	TRANSISTOR
		or RN1309	TRANSISTOR
		or UN521E	TRANSISTOR
Q18		2SB1218A/QR/-X	TRANSISTOR
		or 2PA1576/R/-X	TRANSISTOR
		or 2SA1576A/QR/-X	TRANSISTOR
Q21		2SB1218A/QR/-X	TRANSISTOR
		or 2SA1576A/QR/-X	TRANSISTOR
		or 2PA1576/R/-X	TRANSISTOR
Q24		2SB1218A/QR/-X	TRANSISTOR
		or 2PA1576/R/-X	TRANSISTOR
		or 2SA1576A/QR/-X	TRANSISTOR
Q25		DTC144WU	TRANSISTOR
		or PDTC144WU	TRANSISTOR
		or RN1309	TRANSISTOR
		or UN521E	TRANSISTOR
Q38		2SD1819A/QRS/-X	TRANSISTOR
		or 2PC4081/R/-X	TRANSISTOR

#	△ REF No.	PART No.	PART NAME, DESCRIPTION
		or 2SC4081/QRS/-X	TRANSISTOR
Q41		DTC144WU	TRANSISTOR
		or PDTC144WU	TRANSISTOR
		or RN1309	TRANSISTOR
		or UN521E	TRANSISTOR
Q401		2SA1576A/QR/-X	TRANSISTOR
Q402		2SA1576A/QR/-X	TRANSISTOR
Q403		DTC144WU	TRANSISTOR
		or PDTC144WU	TRANSISTOR
		or RN1309	TRANSISTOR
		or UN521E	TRANSISTOR
Q404		DTC144WU	TRANSISTOR
		or PDTC144WU	TRANSISTOR
		or RN1309	TRANSISTOR
		or UN521E	TRANSISTOR
Q405		2SA1576A/QR/-X	TRANSISTOR
Q2001		2SC4081/QRS/-X	TRANSISTOR
		or 2SD1819A/QRS/-X	TRANSISTOR
		or 2PC4081/R/-X	TRANSISTOR
Q2002		2SC4081/QRS/-X	TRANSISTOR
		or 2PC4081/R/-X	TRANSISTOR
		or 2SD1819A/QRS/-X	TRANSISTOR
Q2003		DTA144WU	TRANSISTOR
		or PDTA144WU	TRANSISTOR
		or RN2309	TRANSISTOR
		or UN511E	TRANSISTOR
Q2004		DTC144WU	TRANSISTOR
		or PDTC144WU	TRANSISTOR
		or RN1309	TRANSISTOR
		or UN521E	TRANSISTOR
Q2052		2SA1576A/QR/-X	TRANSISTOR
		or 2PA1576/R/-X	TRANSISTOR
		or 2SB1218A/QR/-X	TRANSISTOR
Q2053		DTC144WU	TRANSISTOR
		or PDTC144WU	TRANSISTOR
		or RN1309	TRANSISTOR
		or UN521E	TRANSISTOR
Q2054		2SA1576A/QR/-X	TRANSISTOR
		or 2SB1218A/QR/-X	TRANSISTOR
		or 2PA1576/R/-X	TRANSISTOR
Q2061		2SC4081/QRS/-X	TRANSISTOR
		or 2PC4081/R/-X	TRANSISTOR
		or 2SD1819A/QRS/-X	TRANSISTOR
Q2062		2SA1576A/QR/-X	TRANSISTOR
		or 2PA1576/R/-X	TRANSISTOR
		or 2SB1218A/QR/-X	TRANSISTOR
Q2102		DTC114EU	TRANSISTOR,S9700MS
		or PDTC114EU	TRANSISTOR,S9700MS
		or RN1302	TRANSISTOR,S9700MS
		or UN5211	TRANSISTOR,S9700MS
Q2103		2SC4081/QRS/-X	TRANSISTOR,S9700MS
		or 2SD1819A/QRS/-X	TRANSISTOR,S9700MS
		or 2PC4081/R/-X	TRANSISTOR,S9700MS
Q2104		DTA144WU	TRANSISTOR,S9700MS
		or PDTA144WU	TRANSISTOR,S9700MS
		or RN2309	TRANSISTOR,S9700MS
		or UN511E	TRANSISTOR,S9700MS
Q2105		DTC144WU	TRANSISTOR,S9700MS
		or PDTC144WU	TRANSISTOR,S9700MS
		or RN1309	TRANSISTOR,S9700MS
		or UN521E	TRANSISTOR,S9700MS

#	△	REF No.	PART No.	PART NAME, DESCRIPTION	#	△	REF No.	PART No.	PART NAME, DESCRIPTION
Q2108			2SC4081/QRS/-X	TRANSISTOR,S9700MS				2SD1450/ST/-T	TRANSISTOR,S8700MS
			or 2PC4081/R/-X	TRANSISTOR,S9700MS				or 2SD1302/ST/-T	TRANSISTOR,S8700MS
			or 2SD1819A/QRS/-X	TRANSISTOR,S9700MS	Q5305			UN5111	TRANSISTOR
Q2251			DTA144WU	TRANSISTOR				or RN2302	TRANSISTOR
			or PDTA144WU	TRANSISTOR				or DTA114EU	TRANSISTOR
			or RN2309	TRANSISTOR				or PDTA114EU	TRANSISTOR
			or UN511E	TRANSISTOR	Q5306			2SB1239	TRANSISTOR
Q2252			DTC114EU	TRANSISTOR	Q5310			DTC114EU	TRANSISTOR
			or PDTC114EU	TRANSISTOR				or PDTC114EU	TRANSISTOR
			or UN5211	TRANSISTOR				or RN1302	TRANSISTOR
			or RN1302	TRANSISTOR				or UN5211	TRANSISTOR
Q2501			2SC4081/QRS/-X	TRANSISTOR,S9700MS	Q5311			2SA1576A/RS/-X	TRANSISTOR
			or 2SD1819A/QRS/-X	TRANSISTOR,S9700MS	Q5312			2SD2144S/UV/-T	TRANSISTOR
			or 2PC4081/R/-X	TRANSISTOR,S9700MS	Q5318			DTA114EU	TRANSISTOR
Q2502			DTC144WU	TRANSISTOR,S9700MS				or PDTA114EU	TRANSISTOR
			or RN1309	TRANSISTOR,S9700MS				or UN5111	TRANSISTOR
			or UN521E	TRANSISTOR,S9700MS				or RN2302	TRANSISTOR
			or PDTC144WU	TRANSISTOR,S9700MS	Q5320			2SB1256	TRANSISTOR
Q3001			2SD1819A/QRS/-X	TRANSISTOR	Q5321			DTC114TU	TRANSISTOR
			or 2SC4081/QRS/-X	TRANSISTOR				or PDTC114TU	TRANSISTOR
			or 2PC4081/R/-X	TRANSISTOR				or RN1311	TRANSISTOR
Q3002			PTZ-NV16	PHOTO TRANSISTOR				or UN5215	TRANSISTOR
			or PTZ-NV16A	PHOTO TRANSISTOR	Q5322			DTA114EU	TRANSISTOR
Q3003			PTZ-NV16	PHOTO TRANSISTOR				or PDTA114EU	TRANSISTOR
			or PTZ-NV16A	PHOTO TRANSISTOR				or RN2302	TRANSISTOR
Q3004			2SD1819A/QRS/-X	TRANSISTOR				or UN5111	TRANSISTOR
			or 2PC4081/R/-X	TRANSISTOR	Q6030			2SB1218A/QR/-X	TRANSISTOR
			or 2SC4081/QRS/-X	TRANSISTOR				or 2PA1576/R/-X	TRANSISTOR
Q3005			2SD1819A/QRS/-X	TRANSISTOR				or 2SA1576A/QR/-X	TRANSISTOR
			or 2SC4081/QRS/-X	TRANSISTOR	Q6031			DTC114EU	TRANSISTOR
			or 2PC4081/R/-X	TRANSISTOR				or PDTC114EU	TRANSISTOR
Q3007			UN521E	TRANSISTOR				or UN5211	TRANSISTOR
			or RN1309	TRANSISTOR				or RN1302	TRANSISTOR
			or DTC144WU	TRANSISTOR	Q6032			DTC114EU	TRANSISTOR
			or PDTC144WU	TRANSISTOR				or PDTC114EU	TRANSISTOR
Q3009			UN521E	TRANSISTOR,S9700MS				or UN5211	TRANSISTOR
			or PDTC144WU	TRANSISTOR,S9700MS				or RN1302	TRANSISTOR
			or DTC144WU	TRANSISTOR,S9700MS	Q7201			2SC1317/RS/-T	TRANSISTOR
			or RN1309	TRANSISTOR,S9700MS	D6			MTZJ5.1C	ZENER DIODE
Q3501			2SD1819A/QRS/-X	TRANSISTOR,S9700MS	D2001			1SS355	DIODE
			or 2SC4081/QRS/-X	TRANSISTOR,S9700MS	D2121			MTZJ8.2C	ZENER DIODE
			or 2PC4081/R/-X	TRANSISTOR,S9700MS	D2201			11ES2	DIODE
Q4001			UN5211	TRANSISTOR				or 1A3G	DIODE
			or PDTC114EU	TRANSISTOR	D2501			1SS133	DIODE,S9700MS
			or DTC114EU	TRANSISTOR	D3001			LNB2301L01VI	LE DIODE
			or RN1302	TRANSISTOR	D3002			1SS133	DIODE
Q4002			UN5211	TRANSISTOR	D3003			RD39ES/B3/-T2	ZENER DIODE
			or PDTC114EU	TRANSISTOR				or MTZJ39C	ZENER DIODE
			or DTC114EU	TRANSISTOR	D3004			11E2-T5	DIODE
			or RN1302	TRANSISTOR	D3005			11E2-T5	DIODE
Q4003			UN5211	TRANSISTOR	D3007			1SS355	DIODE,S9700MS
			or PDTC114EU	TRANSISTOR				NRSA02J-0R0X	MG RESISTOR,S8700MS
			or DTC114EU	TRANSISTOR	D3008			1SS355	DIODE
			or RN1302	TRANSISTOR	D3011			1SS133	DIODE,S8700MS
Q5301			2SB1256	TRANSISTOR	D3012			1SS133	DIODE,S8700MS
Q5302			DTC114TU	TRANSISTOR	D4001			1SS355	DIODE
			or PDTC114TU	TRANSISTOR	D4002			1SS355	DIODE
			or UN5215	TRANSISTOR	D5001			S1WB/A/60-4102	BRIDGE DIODE
			or RN1311	TRANSISTOR				or S1WB(A)60F4072X	BRIDGE DIODE
△ Q5303			2SD2144S/UVW/-T	TRANSISTOR				or S1WB/A/60-X	BRIDGE DIODE
Q5304			2SC3616/ML/-T	TRANSISTOR,S9700MS	D5101			AU01	FR DIODE

#	△ REF No.	PART No.	PART NAME, DESCRIPTION	#	△ REF No.	PART No.	PART NAME, DESCRIPTION
		or ERA18-04-T2	FR DIODE	D5310		MTZJ11C	ZENER DIODE
		or 1SR153-400-T2	FR DIODE			or RD11ES/B3/-T2	ZENER DIODE
		or 10ELS4	FR DIODE	D5315		11ES2	DIODE
D5102		AU01	FR DIODE			or 1A3G	DIODE
		or ERA18-04-T2	FR DIODE			or ERA15-02-T2	DIODE
		or 10ELS4	FR DIODE	D6002		HZ30-2L-T2	ZENER DIODE
		or 1SR153-400-T2	FR DIODE			or HZ30-2LTD	Z DIODE (M)
D5103		AU01Z	FR DIODE	R1		NRSA02J-682X	MG RESISTOR 6.8kΩ,1/10W
		or ERA18-02-T2	FR DIODE	R2		NRSA02J-152X	MG RESISTOR 1.5kΩ,1/10W
		or PG104RS	FR DIODE	R4		NRSA02J-0R0X	MG RESISTOR 0Ω,1/10W
		or 10ELS2	FR DIODE	R5		NRSA02J-0R0X	MG RESISTOR 0Ω,1/10W
		or 1SR153-400-T2	FR DIODE	R6		NRSA02J-273X	MG RESISTOR 27kΩ,1/10W
D5201		AK04	DIODE	R7		NRSA02J-681X	MG RESISTOR 680Ω,1/10W
		or 1S4	SB DIODE	R8		NRSA02J-0R0X	MG RESISTOR 0Ω,1/10W
		or 11EQS04	SB DIODE	R9		NRSA02J-0R0X	MG RESISTOR 0Ω,1/10W
D5202		FML-12S	FR DIODE	R23		NRSA02J-182X	MG RESISTOR 1.8kΩ,1/10W
		or FCF06A20	FR DIODE	R24		NRSA02J-331X	MG RESISTOR 330Ω,1/10W
		or YG901C2	FR DIODE	R25		NRSA02J-103X	MG RESISTOR 10kΩ,1/10W
		or SF5LC20U	FR DIODE	R26		NRSA02J-682X	MG RESISTOR 6.8kΩ,1/10W
D5206		FMB-24	BARRIER DIODE	R27		NRSA02J-221X	MG RESISTOR 220Ω,1/10W
		or FSQ05A04B	SB DIODE	R28		NRSA02J-221X	MG RESISTOR 220Ω,1/10W
		or YG801C04	SB DIODE	R29		NRSA02J-681X	MG RESISTOR 680Ω,1/10W
		or SB640FCT	SB DIODE	R30		NRSA02J-0R0X	MG RESISTOR 0Ω,1/10W
		or SF5SC4	SB DIODE	R31		NRSA02J-152X	MG RESISTOR 1.5kΩ,1/10W
D5209		ERA18-02-T2	FR DIODE	R32		NRSA02J-471X	MG RESISTOR 470Ω,1/10W
		or 1SR153-400-T2	FR DIODE	R33		NDC21HJ-8R0X	CAPACITOR 8pF,50V
		or 10ELS2	FR DIODE	R34		NDC21HJ-390X	CAPACITOR 39pF,50V
		or PG104RS	FR DIODE	R36		NRSA02J-182X	MG RESISTOR 1.8kΩ,1/10W
D5210		AU01Z	FR DIODE	R38		NRSA02J-102X	MG RESISTOR 1kΩ,1/10W
		or PG104RS	FR DIODE	R40		NRSA02J-222X	MG RESISTOR 2.2kΩ,1/10W
		or 1SR153-400-T2	FR DIODE	R41		NRSA02J-392X	MG RESISTOR 3.9kΩ,1/10W
		or 10ELS2	FR DIODE	R42		NRSA02J-681X	MG RESISTOR 680Ω,1/10W
		or ERA18-02-T2	FR DIODE	R46		NRSA02J-271X	MG RESISTOR 270Ω,1/10W
D5211		AU01Z	FR DIODE	R47		NRSA02J-821X	MG RESISTOR 820Ω,1/10W
		or ERA18-02-T2	FR DIODE	R48		NRSA02J-102X	MG RESISTOR 1kΩ,1/10W
		or PG104RS	FR DIODE	R51		NRSA02J-122X	MG RESISTOR 1.2kΩ,1/10W
		or 10ELS2	FR DIODE	R54		NRSA02J-152X	MG RESISTOR 1.5kΩ,1/10W
		or 1SR153-400-T2	FR DIODE	R62		NRSA02J-101X	MG RESISTOR 100Ω,1/10W
D5214		ERA18-02-T2	FR DIODE	R68		NRSA02J-222X	MG RESISTOR 2.2kΩ,1/10W
		or PG104RS	FR DIODE	R70		NRSA02J-0R0X	MG RESISTOR 0Ω,1/10W
		or 10ELS2	FR DIODE	R77		NRSA02J-103X	MG RESISTOR 10kΩ,1/10W
		or 1SR153-400-T2	FR DIODE	R88		NRSA02J-0R0X	MG RESISTOR 0Ω,1/10W
D5301		MTZJ15A	ZENER DIODE	R90		NRSA02J-391X	MG RESISTOR 390Ω,1/10W
		or RD15ES/B1/-T2	ZENER DIODE	R92		NRSA02J-152X	MG RESISTOR 1.5kΩ,1/10W
D5302		MTZJ6.8A	ZENER DIODE	R93		NRSA02J-222X	MG RESISTOR 2.2kΩ,1/10W
		or RD6.8ES/B1/-T2	ZENER DIODE	R104		NRSA02J-682X	MG RESISTOR 6.8kΩ,1/10W
D5303		MTZJ27C	ZENER DIODE	R113		NRSA02J-101X	MG RESISTOR 100Ω,1/10W
		or RD27ES/B3/-T2	ZENER DIODE	R114		NRSA02J-0R0X	MG RESISTOR 0Ω,1/10W
D5304		1SS133	DIODE	R117		NRSA02J-104X	MG RESISTOR 100kΩ,1/10W
		or 1SS270A	DIODE	R401		NRSA02J-221X	MG RESISTOR 220Ω,1/10W
D5305		11ES2	DIODE	R402		NRSA02J-681X	MG RESISTOR 680Ω,1/10W
		or 1A3G	DIODE	R403		NRSA02J-561X	MG RESISTOR 560Ω,1/10W
		or ERA15-02-T2	DIODE	R404		NRSA02J-473X	MG RESISTOR 47kΩ,1/10W
D5306		MTZJ12A	ZENER DIODE	R405		NRSA02J-683X	MG RESISTOR 68kΩ,1/10W
		or RD12ES/B1/-T2	ZENER DIODE	R406		NRSA02J-393X	MG RESISTOR 39kΩ,1/10W
D5307		1SS133	DIODE	R407		NRSA02J-472X	MG RESISTOR 4.7kΩ,1/10W
		or 1SS270A	DIODE	R408		NRSA02J-473X	MG RESISTOR 47kΩ,1/10W
D5308		1SS133	DIODE	R409		NRSA02J-103X	MG RESISTOR 10kΩ,1/10W
		or 1SS270A	DIODE	R2003		QRE141J-101Y	RESISTOR 100Ω,1/4W
D5309		1SS133	DIODE	R2005		QRE141J-0R0Y	RESISTOR 0Ω,1/4W
		or 1SS270A	DIODE	R2006		QRE141J-393Y	RESISTOR 39kΩ,1/4W

#	△	REF No.	PART No.	PART NAME, DESCRIPTION	#	△	REF No.	PART No.	PART NAME, DESCRIPTION
R2007			NRSA02J-393X	MG RESISTOR 39kΩ,1/10W	R2502			NRSA02J-562X	MG RESISTOR,S9700MS 5.6kΩ,1/10W
R2008			NRSA02J-123X	MG RESISTOR 12kΩ,1/10W	R2503			NRSA02J-563X	MG RESISTOR,S9700MS 56kΩ,1/10W
R2009			NRSA02J-123X	MG RESISTOR 12kΩ,1/10W	R2504			NRSA02J-472X	MG RESISTOR,S9700MS 4.7kΩ,1/10W
R2010			NRSA02J-123X	MG RESISTOR 12kΩ,1/10W	R2505			NRSA02J-105X	MG RESISTOR,S9700MS 1MΩ,1/10W
R2011			NRSA02J-103X	MG RESISTOR 10kΩ,1/10W	R2506			NRSA02J-473X	MG RESISTOR,S9700MS 47kΩ,1/10W
R2012			NRSA02J-153X	MG RESISTOR 15kΩ,1/10W	R2507			NRSA02J-102X	MG RESISTOR,S9700MS 1kΩ,1/10W
R2013			NRSA02J-682X	MG RESISTOR 6.8kΩ,1/10W	R2508			NRSA02J-333X	MG RESISTOR,S9700MS 33kΩ,1/10W
R2014			NRSA02J-224X	MG RESISTOR 220kΩ,1/10W	R2509			NRSA02J-103X	MG RESISTOR,S9700MS 10kΩ,1/10W
R2015			NRSA02J-181X	MG RESISTOR,S8700MS 180Ω,1/10W	R2510			NRSA02J-104X	MG RESISTOR,S9700MS 100kΩ,1/10W
			NRSA02J-271X	MG RESISTOR,S9700MS 270Ω,1/10W	R2511			NRSA02J-124X	MG RESISTOR,S9700MS 120kΩ,1/10W
R2016			NRSA02J-393X	MG RESISTOR 39kΩ,1/10W	R2512			NRSA02J-102X	MG RESISTOR,S9700MS 1kΩ,1/10W
R2017			NRSA02J-183X	MG RESISTOR 18kΩ,1/10W	R2513			NRSA02J-102X	MG RESISTOR,S9700MS 1kΩ,1/10W
R2018			NRSA02J-472X	MG RESISTOR 4.7kΩ,1/10W	R2514			NRSA02J-562X	MG RESISTOR,S9700MS 5.6kΩ,1/10W
R2019			NRSA02J-472X	MG RESISTOR 4.7kΩ,1/10W	R2519			NRSA02J-102X	MG RESISTOR,S9700MS 1kΩ,1/10W
R2020			NRSA02J-102X	MG RESISTOR 1kΩ,1/10W	R2520			NRSA02J-101X	MG RESISTOR,S9700MS 100Ω,1/10W
R2053			NRSA02J-472X	MG RESISTOR 4.7kΩ,1/10W	R2522			NRSA02J-682X	MG RESISTOR,S9700MS 6.8kΩ,1/10W
R2056			NRSA02J-101X	MG RESISTOR 100Ω,1/10W	R3011			QRE141J-0R0Y	RESISTOR 0Ω,1/4W
R2057			NRSA02J-473X	MG RESISTOR 47kΩ,1/10W	R3012			NRSA02J-0R0X	MG RESISTOR 0Ω,1/10W
R2058			NRSA02J-183X	MG RESISTOR 18kΩ,1/10W	R3013			NRSA02J-0R0X	MG RESISTOR 0Ω,1/10W
R2059			NRSA02J-473X	MG RESISTOR 47kΩ,1/10W	R3016			QRE141J-0R0Y	RESISTOR 0Ω,1/4W
R2060			NRSA02J-183X	MG RESISTOR 18kΩ,1/10W	R3017			QRE141J-0R0Y	RESISTOR 0Ω,1/4W
R2061			NRSA02J-273X	MG RESISTOR 27kΩ,1/10W	R3018			QRE141J-682Y	RESISTOR 6.8kΩ,1/4W
R2062			NRSA02J-3R3X	MG RESISTOR 3.3Ω,1/10W	R3019			QRE141J-0R0Y	RESISTOR 0Ω,1/4W
R2063			NRSA02J-151X	MG RESISTOR 150Ω,1/10W	R3022			NRSA02J-0R0X	MG RESISTOR 0Ω,1/10W
R2064			NRSA02J-473X	MG RESISTOR 47kΩ,1/10W	R3025			NRSA02J-0R0X	MG RESISTOR 0Ω,1/10W
R2065			NRSA02J-183X	MG RESISTOR 18kΩ,1/10W	R3026			NRSA02J-0R0X	MG RESISTOR 0Ω,1/10W
R2102			NRSA02J-471X	MG RESISTOR,S9700MS 470Ω,1/10W	R3027			NRSA02J-0R0X	MG RESISTOR 0Ω,1/10W
R2103			NRSA02J-472X	MG RESISTOR,S9700MS 4.7kΩ,1/10W	R3029			NRSA02J-472X	MG RESISTOR 4.7kΩ,1/10W
R2104			NRSA02J-472X	MG RESISTOR,S9700MS 4.7kΩ,1/10W	R3030			NRSA02J-472X	MG RESISTOR 4.7kΩ,1/10W
R2105			NRSA02J-103X	MG RESISTOR,S9700MS 10kΩ,1/10W	R3031			NRSA02J-0R0X	MG RESISTOR 0Ω,1/10W
R2106			NRSA02J-681X	MG RESISTOR,S9700MS 680Ω,1/10W	R3032			NRSA02J-0R0X	MG RESISTOR 0Ω,1/10W
R2107			NRSA02J-122X	MG RESISTOR,S9700MS 1.2kΩ,1/10W	R3038			NRSA02J-152X	MG RESISTOR 1.5kΩ,1/10W
R2109			NRSA02J-103X	MG RESISTOR,S9700MS 10kΩ,1/10W	R3040			NRSA02J-0R0X	MG RESISTOR 0Ω,1/10W
R2111			NRSA02J-222X	MG RESISTOR,S9700MS 2.2kΩ,1/10W	R3041			NRSA02J-472X	MG RESISTOR 4.7kΩ,1/10W
R2121			QRE141J-151Y	RESISTOR 150Ω,1/4W	R3042			NRSA02J-0R0X	MG RESISTOR 0Ω,1/10W
R2202			NRSA02J-222X	MG RESISTOR 2.2kΩ,1/10W	R3044			QRE141J-0R0Y	RESISTOR 0Ω,1/4W
R2203			NRSA02J-222X	MG RESISTOR 2.2kΩ,1/10W	R3046			QRE141J-102Y	RESISTOR 1kΩ,1/4W
R2204			NRSA02J-102X	MG RESISTOR 1kΩ,1/10W	R3047			QRE141J-102Y	RESISTOR 1kΩ,1/4W
R2205			NRSA02J-102X	MG RESISTOR 1kΩ,1/10W	R3048			QRE141J-102Y	RESISTOR 1kΩ,1/4W
R2206			QRE141J-101Y	RESISTOR 100Ω,1/4W	R3049			NRSA02J-0R0X	MG RESISTOR 0Ω,1/10W
R2208			QRE141J-101Y	RESISTOR 100Ω,1/4W	R3050			NRSA02J-0R0X	MG RESISTOR 0Ω,1/10W
R2209			QRE141J-101Y	RESISTOR 100Ω,1/4W	R3051			NRSA02J-471X	MG RESISTOR 470Ω,1/10W
R2210			NRSA02J-103X	MG RESISTOR 10kΩ,1/10W	R3052			NRSA02J-471X	MG RESISTOR 470Ω,1/10W
R2211			NRSA02J-103X	MG RESISTOR 10kΩ,1/10W	R3053			NRSA02J-471X	MG RESISTOR 470Ω,1/10W
R2213			QRE141J-393Y	RESISTOR 39kΩ,1/4W	R3054			NRSA02J-0R0X	MG RESISTOR 0Ω,1/10W
R2215			NRSA02J-153X	MG RESISTOR 15kΩ,1/10W	R3055			NRSA02J-0R0X	MG RESISTOR 0Ω,1/10W
R2217			NRSA02J-0R0X	MG RESISTOR 0Ω,1/10W	R3056			NRSA02J-102X	MG RESISTOR 1kΩ,1/10W
R2218			NRSA02J-393X	MG RESISTOR 39kΩ,1/10W	R3057			NRSA02J-102X	MG RESISTOR 1kΩ,1/10W
R2219			QRE141J-393Y	RESISTOR 39kΩ,1/4W	R3058			NRSA02J-102X	MG RESISTOR 1kΩ,1/10W
R2220			QRE141J-393Y	RESISTOR 39kΩ,1/4W	R3059			NRSA02J-0R0X	MG RESISTOR 0Ω,1/10W
R2222			NRSA02J-123X	MG RESISTOR 12kΩ,1/10W	R3060			NRSA02J-471X	MG RESISTOR 470Ω,1/10W
R2223			NRSA02J-123X	MG RESISTOR 12kΩ,1/10W	R3061			NRSA02J-471X	MG RESISTOR 470Ω,1/10W
R2224			NRSA02J-123X	MG RESISTOR 12kΩ,1/10W	R3062			NRSA02J-0R0X	MG RESISTOR 0Ω,1/10W
R2225			NRSA02J-153X	MG RESISTOR 15kΩ,1/10W	R3063			NRSA02J-472X	MG RESISTOR,S9700MS 4.7kΩ,1/10W
R2226			NRSA02J-123X	MG RESISTOR 12kΩ,1/10W				NRSA02J-0R0X	MG RESISTOR,S8700MS 0Ω,1/10W
R2227			NRSA02J-123X	MG RESISTOR 12kΩ,1/10W	R3066			NRSA02J-472X	MG RESISTOR 4.7kΩ,1/10W
R2228			NRSA02J-103X	MG RESISTOR 10kΩ,1/10W	R3069			NRSA02J-101X	MG RESISTOR 100Ω,1/10W
R2229			QRE141J-563Y	RESISTOR 56kΩ,1/4W	R3071			NRSA02J-103X	MG RESISTOR 10kΩ,1/10W
R2251			NRSA02J-102X	MG RESISTOR 1kΩ,1/10W	R3072			NRSA02J-0R0X	MG RESISTOR 0Ω,1/10W
R2252			NRSA02J-472X	MG RESISTOR 4.7kΩ,1/10W	R3073			NRSA02J-0R0X	MG RESISTOR 0Ω,1/10W
R2501			NRSA02J-0R0X	MG RESISTOR,S9700MS 0Ω,1/10W	R3075			NRSA02J-471X	MG RESISTOR 470Ω,1/10W

#	△ REF No.	PART No.	PART NAME, DESCRIPTION	#	△ REF No.	PART No.	PART NAME, DESCRIPTION
R3076		NRSA02J-471X	MG RESISTOR 470Ω,1/10W	R3671		NRSA02J-103X	MG RESISTOR 10kΩ,1/10W
R3078		NRSA02J-0R0X	MG RESISTOR 0Ω,1/10W	R3672		NRSA02J-102X	MG RESISTOR,S9700MS 1kΩ,1/10W
R3083		NRSA02J-0R0X	MG RESISTOR 0Ω,1/10W			NRSA02J-103X	MG RESISTOR,S8700MS 10kΩ,1/10W
R3085		NRSA02J-0R0X	MG RESISTOR 0Ω,1/10W	R3673		NRSA02J-103X	MG RESISTOR 10kΩ,1/10W
R3086		NRSA02J-0R0X	MG RESISTOR 0Ω,1/10W	R4001		NRSA02J-472X	MG RESISTOR 4.7kΩ,1/10W
R3087		NRSA02J-0R0X	MG RESISTOR 0Ω,1/10W	R4003		NRSA02J-561X	MG RESISTOR 560Ω,1/10W
R3088		NRSA02J-0R0X	MG RESISTOR 0Ω,1/10W	R4004		NRSA02J-561X	MG RESISTOR 560Ω,1/10W
R3089		NRSA02J-0R0X	MG RESISTOR 0Ω,1/10W	R4005		NRSA02J-562X	MG RESISTOR 5.6kΩ,1/10W
R3090		NRSA02J-0R0X	MG RESISTOR 0Ω,1/10W	R4007		NRSA02J-102X	MG RESISTOR 1kΩ,1/10W
R3091		NRSA02J-102X	MG RESISTOR 1kΩ,1/10W	R4008		NRSA02J-102X	MG RESISTOR 1kΩ,1/10W
R3094		QRE141J-0R0Y	RESISTOR 0Ω,1/4W	R4009		NRSA02J-102X	MG RESISTOR 1kΩ,1/10W
R3095		QRE141J-0R0Y	RESISTOR 0Ω,1/4W	R4010		NRSA02J-103X	MG RESISTOR 10kΩ,1/10W
R3096		QRE141J-0R0Y	RESISTOR 0Ω,1/4W	R4011		NRSA02J-472X	MG RESISTOR 4.7kΩ,1/10W
R3097		NRSA02J-0R0X	MG RESISTOR 0Ω,1/10W	R4012		NRSA02J-222X	MG RESISTOR 2.2kΩ,1/10W
R3103		NRSA02J-0R0X	MG RESISTOR 0Ω,1/10W	R4013		NRSA02J-102X	MG RESISTOR 1kΩ,1/10W
R3105		NRSA02J-102X	MG RESISTOR 1kΩ,1/10W	R4014		NRSA02J-0R0X	MG RESISTOR 0Ω,1/10W
R3106		NRSA02J-102X	MG RESISTOR 1kΩ,1/10W	R4015		NRSA02J-223X	MG RESISTOR 22kΩ,1/10W
R3201		NRSA02J-103X	MG RESISTOR 10kΩ,1/10W	R4016		NRSA02J-103X	MG RESISTOR 10kΩ,1/10W
R3202		NRSA02J-472X	MG RESISTOR 4.7kΩ,1/10W	R4017		NRSA02J-102X	MG RESISTOR 1kΩ,1/10W
R3203		NRSA02J-103X	MG RESISTOR 10kΩ,1/10W	R4018		NRSA02J-102X	MG RESISTOR 1kΩ,1/10W
R3204		NRSA02J-222X	MG RESISTOR 2.2kΩ,1/10W	R4019		NRSA02J-103X	MG RESISTOR 10kΩ,1/10W
R3205		QRE141J-181Y	RESISTOR 180Ω,1/4W	R4020		NRSA02J-103X	MG RESISTOR 10kΩ,1/10W
R3206		QRE141J-183Y	RESISTOR 18kΩ,1/4W	R4021		NRSA02J-103X	MG RESISTOR 10kΩ,1/10W
R3207		NRSA02J-183X	MG RESISTOR 18kΩ,1/10W	R5101		QRG02GJ-104	OMF RESISTOR 100kΩ,2W
R3208		NRSA02J-181X	MG RESISTOR 180Ω,1/10W	R5102		QRE141J-390Y	RESISTOR 39Ω,1/4W
R3209		NRSA02J-273X	MG RESISTOR 27kΩ,1/10W	R5103		NRSA02J-681X	MG RESISTOR 680Ω,1/10W
R3210		NRSA02J-181X	MG RESISTOR 180Ω,1/10W	R5104		QRG029J-154G	OMF RESISTOR 150kΩ,2W
R3211		NRSA02J-273X	MG RESISTOR 27kΩ,1/10W	R5105		QRT01DJ-R39X	MF RESISTOR 0.39Ω,1W
R3212		NRSA02J-474X	MG RESISTOR 470kΩ,1/10W	R5106		NRSA02J-562X	MG RESISTOR 5.6kΩ,1/10W
R3213		NRSA02J-334X	MG RESISTOR 330kΩ,1/10W	R5301		QRE141J-1R0Y	RESISTOR 1Ω,1/4W
R3214		NRSA02J-103X	MG RESISTOR 10kΩ,1/10W	R5302		NRSA02J-102X	MG RESISTOR 1kΩ,1/10W
R3215		NRSA02J-103X	MG RESISTOR 10kΩ,1/10W	R5303		NRSA02J-122X	MG RESISTOR 1.2kΩ,1/10W
R3216		NRSA02J-103X	MG RESISTOR 10kΩ,1/10W	△ R5304		QRZ9005-221X	FUSI RESISTOR 220Ω,1/4W
R3217		NRSA02J-562X	MG RESISTOR 5.6kΩ,1/10W	R5305		NRSA02J-471X	MG RESISTOR 470Ω,1/10W
R3218		QRE141J-472Y	RESISTOR 4.7kΩ,1/4W	R5306		NRSA02J-683X	MG RESISTOR 68kΩ,1/10W
R3219		NRSA02J-472X	MG RESISTOR 4.7kΩ,1/10W	R5307		NRSA02J-102X	MG RESISTOR 1kΩ,1/10W
R3220		NRSA02J-104X	MG RESISTOR 100kΩ,1/10W	R5308		NRSA02J-472X	MG RESISTOR 4.7kΩ,1/10W
R3222		NRSA02J-472X	MG RESISTOR 4.7kΩ,1/10W	R5309		QRE141J-222Y	RESISTOR 2.2kΩ,1/4W
R3223		NRSA02J-472X	MG RESISTOR 4.7kΩ,1/10W	R5310		NRSA02J-472X	MG RESISTOR 4.7kΩ,1/10W
R3224		NRSA02J-472X	MG RESISTOR 4.7kΩ,1/10W	R5311		NRSA02J-222X	MG RESISTOR 2.2kΩ,1/10W
R3225		NRSA02J-103X	MG RESISTOR 10kΩ,1/10W	R5313		QRE141J-222Y	RESISTOR 2.2kΩ,1/4W
R3229		NRSA02J-105X	MG RESISTOR 1MΩ,1/10W	R5314		NRSA02J-102X	MG RESISTOR 1kΩ,1/10W
R3230		NRSA02J-472X	MG RESISTOR 4.7kΩ,1/10W	R5317		NRSA02J-273X	MG RESISTOR 27kΩ,1/10W
R3231		NRSA02J-102X	MG RESISTOR 1kΩ,1/10W	R5318		NRSA02J-273X	MG RESISTOR 27kΩ,1/10W
R3233		NRSA02J-103X	MG RESISTOR 10kΩ,1/10W	R5319		QRE141J-221Y	RESISTOR 220Ω,1/4W
R3234		NRSA02J-103X	MG RESISTOR 10kΩ,1/10W	R5321		QRE141J-221Y	RESISTOR 220Ω,1/4W
R3235		NRSA02J-222X	MG RESISTOR 2.2kΩ,1/10W	R5322		NRSA02J-473X	MG RESISTOR 47kΩ,1/10W
R3236		NRSA02J-332X	MG RESISTOR 3.3kΩ,1/10W	R5323		NRSA02J-473X	MG RESISTOR 47kΩ,1/10W
R3237		NRSA02J-103X	MG RESISTOR 10kΩ,1/10W	R5327		NRVA02D-303X	CMF RESISTOR 30kΩ,1/10W
R3238		QRE141J-103Y	RESISTOR 10kΩ,1/4W	R5329		NRSA02J-103X	MG RESISTOR 10kΩ,1/10W
R3239		NRSA02J-103X	MG RESISTOR 10kΩ,1/10W	R5330		NRSA02J-103X	MG RESISTOR 10kΩ,1/10W
R3241		NRSA02J-104X	MG RESISTOR 100kΩ,1/10W	R5332		NRSA02J-103X	MG RESISTOR 10kΩ,1/10W
R3242		NRSA02J-472X	MG RESISTOR 4.7kΩ,1/10W	R5334		QRE141J-103Y	RESISTOR 10kΩ,1/4W
R3244		NRSA02J-103X	MG RESISTOR 10kΩ,1/10W	R5335		NRSA02J-472X	MG RESISTOR 4.7kΩ,1/10W
R3251		NRSA02J-103X	MG RESISTOR 10kΩ,1/10W	R5336		NRSA02J-222X	MG RESISTOR 2.2kΩ,1/10W
R3501		NRSA02J-153X	MG RESISTOR,S9700MS 15kΩ,1/10W	R6020		NRSA02J-0R0X	MG RESISTOR 0Ω,1/10W
R3502		NRSA02J-272X	MG RESISTOR,S9700MS 2.7kΩ,1/10W	R6021		NRSA02J-0R0X	MG RESISTOR 0Ω,1/10W
R3503		NRSA02J-153X	MG RESISTOR,S9700MS 15kΩ,1/10W	R6022		NRSA02J-0R0X	MG RESISTOR 0Ω,1/10W
R3504		NRSA02J-223X	MG RESISTOR,S9700MS 22kΩ,1/10W	R6030		NRSA02J-102X	MG RESISTOR 1kΩ,1/10W
R3505		NRSA02J-562X	MG RESISTOR,S9700MS 5.6kΩ,1/10W	R6031		NRSA02J-0R0X	MG RESISTOR 0Ω,1/10W
R3506		NRSA02J-123X	MG RESISTOR,S9700MS 12kΩ,1/10W	R6032		NRSA02J-332X	MG RESISTOR 3.3kΩ,1/10W

#	△	REF No.	PART No.	PART NAME, DESCRIPTION		#	△	REF No.	PART No.	PART NAME, DESCRIPTION	
R6033			NRSA02J-182X	MG RESISTOR	1.8kΩ,1/10W	C76			NCB21HK-103X	CAPACITOR	0.01μF,50V
R6060			NRSA02J-103X	MG RESISTOR	10kΩ,1/10W	C77			NCB21HK-103X	CAPACITOR	0.01μF,50V
R6061			NRSA02J-103X	MG RESISTOR	10kΩ,1/10W	C78			NCB21HK-103X	CAPACITOR	0.01μF,50V
R6508			NRSA02J-0R0X	MG RESISTOR	0Ω,1/10W	C79			NDC21HJ-390X	CAPACITOR	39pF,50V
R6510			NRSA02J-0R0X	MG RESISTOR	0Ω,1/10W	C80			NCB21HK-103X	CAPACITOR	0.01μF,50V
R6553			QRE141J-471Y	RESISTOR	470Ω,1/4W	C84			NRSA02J-682X	MG RESISTOR	6.8kΩ,1/10W
R6554			QRE141J-471Y	RESISTOR	470Ω,1/4W	C93			NDC21HJ-220X	CAPACITOR	22pF,50V
R7202			NRSA02J-221X	MG RESISTOR	220Ω,1/10W	C94			NRSA02J-0R0X	MG RESISTOR	0Ω,1/10W
R7203			NRSA02J-472X	MG RESISTOR	4.7kΩ,1/10W	C103			NCB21HK-103X	CAPACITOR	0.01μF,50V
R7204			QRE121J-100Y	RESISTOR	10Ω,1/2W	C106			NCB21HK-821X	CAPACITOR	820pF,50V
R7251			NRSA02J-750X	MG RESISTOR	75Ω,1/10W	C107			NBE20JM-226X	T CAPACITOR	22μF,6.3V
R7252			NRSA02J-750X	MG RESISTOR	75Ω,1/10W	C108			NDC21HJ-680X	CAPACITOR	68pF,50V
R7253			NRSA02J-750X	MG RESISTOR	75Ω,1/10W	C109			NCB21CK-224X	CAPACITOR	0.22μF,16V
C1			NCB21EK-104X	CAPACITOR	0.1μF,25V	C110			NDC21HJ-820X	CAPACITOR	82pF,50V
C2			NCB21EK-104X	CAPACITOR	0.1μF,25V	C114			NDC21HJ-181X	CAPACITOR	180pF,50V
C3			NCB21EK-104X	CAPACITOR	0.1μF,25V	C401			NCB21HK-103X	CAPACITOR	0.01μF,50V
C4			NCB21EK-104X	CAPACITOR	0.1μF,25V	C402			NCB21HK-223X	CAPACITOR	0.022μF,50V
C5			QEK00JM-337	E CAPACITOR	330μF,6.3V	C403			NDC21HJ-131X	CAPACITOR	130pF,50V
C6			NCB11EK-104X	CAPACITOR	0.1μF,25V	C404			NDC21HJ-470X	CAPACITOR	47pF,50V
C7			NCB21HK-102X	CAPACITOR	0.001μF,50V	C406			NCB21HK-102X	CAPACITOR	0.001μF,50V
C8			NCB21EK-104X	CAPACITOR	0.1μF,25V	C407			NDC21HJ-150X	CAPACITOR	15pF,50V
C9			QETN1HM-225	E CAPACITOR	2.2μF,50V	C2001			QETN1HM-475	E CAPACITOR,S8700MS	4.7μF,50V
C10			NDC21HJ-151X	CAPACITOR	150pF,50V				QTE1H44-475Z	E CAPACITOR,S9700MS	4.7μF,50V
C11			NCB21EK-104X	CAPACITOR	0.1μF,25V	C2002			QEKJ1CM-106	E CAPACITOR	10μF,16V
C14			NCB21EK-104X	CAPACITOR	0.1μF,25V	C2003			QEKJ0JM-476	E CAPACITOR	47μF,6.3V
C15			NCB21EK-103X	CAPACITOR	0.01μF,25V	C2004			NCB21HK-103X	CAPACITOR	0.01μF,50V
C16			NCB11EK-104X	CAPACITOR	0.1μF,25V	C2005			QEKJ1EM-475	E CAPACITOR	4.7μF,25V
C17			QEKJ1HM-335	E CAPACITOR	3.3μF,50V	C2006			NCB21HK-123X	CAPACITOR	0.012μF,50V
C18			QEKJ1HM-105	E CAPACITOR	1μF,50V	C2007			QEKJ1CM-226	E CAPACITOR	22μF,16V
C19			QEKJ1HM-225	E CAPACITOR	2.2μF,50V	C2008			QERF1EM-475	E CAPACITOR	4.7μF,25V
C20			QEKJ1HM-105	E CAPACITOR	1μF,50V	C2009			NCB21HK-102X	CAPACITOR	0.001μF,50V
C21			NCB21EK-104X	CAPACITOR	0.1μF,25V	C2010			NCB21HK-152X	CAPACITOR	0.0015μF,50V
C22			QEKJ0JM-227	E CAPACITOR	220μF,6.3V	C2011			QEKJ1EM-475	E CAPACITOR	4.7μF,25V
C23			NCB21EK-104X	CAPACITOR	0.1μF,25V	C2012			QEKJ1EM-475	E CAPACITOR	4.7μF,25V
C24			NCB21EK-104X	CAPACITOR	0.1μF,25V	C2013			NCB21HK-331X	CAPACITOR	330pF,50V
C25			NDC21HJ-6R0X	CAPACITOR	6pF,50V	C2051			NCB21HK-331X	CAPACITOR	330pF,50V
C26			NCB21EK-104X	CAPACITOR	0.1μF,25V	C2052			QFLC1HJ-333Z	F CAPACITOR	0.033μF,50V
C27			NCB21HK-223X	CAPACITOR	0.022μF,50V	C2061			QFLC1HJ-333Z	F CAPACITOR	0.033μF,50V
C28			QEKJ1HM-335	E CAPACITOR	3.3μF,50V	C2062			NCB21HK-332X	CAPACITOR	0.0033μF,50V
C29			NCB21EK-333X	CAPACITOR	0.033μF,25V	C2063			NCB21HK-103X	CAPACITOR	0.01μF,50V
C30			NCB21CK-474X	CAPACITOR	0.47μF,16V	C2064			QEKJ1CM-106	E CAPACITOR	10μF,16V
C31			QEKJ0JM-107	E CAPACITOR	100μF,6.3V	C2101			QEKJ1CM-106	E CAPACITOR,S9700MS	10μF,16V
C32			QCB1HK-103	CAPACITOR	0.01μF,50V	C2102			QEKJ1CM-106	E CAPACITOR,S9700MS	10μF,16V
C33			QEKJ1HM-225	E CAPACITOR	2.2μF,50V	C2104			NCB21CK-104X	CAPACITOR,S9700MS	0.1μF,16V
C34			NCB21EK-104X	CAPACITOR	0.1μF,25V	C2201			NCB21EK-104X	CAPACITOR,S8700MS	0.1μF,25V
C35			NCB21HK-103X	CAPACITOR	0.01μF,50V	C2202			NCB21EK-333X	CAPACITOR	0.033μF,25V
C36			QEKJ1EM-475	E CAPACITOR	4.7μF,25V	C2203			QEKJ1CM-106	E CAPACITOR	10μF,16V
C37			NCB21AK-105X	CAPACITOR	1μF,10V	C2204			QDGB1HK-102Y	CAPACITOR	0.001μF,50V
C38			QEKJ0JM-337	E CAPACITOR	330μF,6.3V	C2207			QEKJ1CM-476	E CAPACITOR,S8700MS	47μF,16V
C39			NCB21EK-104X	CAPACITOR	0.1μF,25V				QTE1E41-476	E CAPACITOR,S9700MS	47μF,25V
C40			QEKJ1CM-106	E CAPACITOR	10μF,16V	C2208			QETN1HM-475	E CAPACITOR,S8700MS	4.7μF,50V
C45			QCFB1HZ-104	CAPACITOR	0.1μF,50V				QTE1H44-475Z	E CAPACITOR,S9700MS	4.7μF,50V
C53			NDC21HJ-101X	CAPACITOR	100pF,50V	C2209			QERF1HM-104	E CAPACITOR	0.1μF,50V
C59			NCB21EK-104X	CAPACITOR	0.1μF,25V	C2210			QEKJ1HM-104	E CAPACITOR	0.1μF,50V
C60			QEKJ0JM-227	E CAPACITOR	220μF,6.3V	C2211			QERF1HM-105	E CAPACITOR	1μF,50V
C61			NCB21HK-103X	CAPACITOR	0.01μF,50V	C2212			QEKJ1HM-105	E CAPACITOR	1μF,50V
C63			NCB21EK-104X	CAPACITOR	0.1μF,25V	C2213			QEKJ1CM-106	E CAPACITOR	10μF,16V
C64			NDC21HJ-220X	CAPACITOR	22pF,50V	C2214			QEKJ1CM-106	E CAPACITOR	10μF,16V
C65			QEKJ1HM-105	E CAPACITOR	1μF,50V	C2215			QERF1EM-475	E CAPACITOR	4.7μF,25V
C72			NDC21HJ-470X	CAPACITOR	47pF,50V	C2216			QEKJ1HM-474	E CAPACITOR	0.47μF,50V
C73			NDC21HJ-120X	CAPACITOR	12pF,50V	C2217			QEKJ1CM-106	E CAPACITOR	10μF,16V

#	△ REF No.	PART No.	PART NAME, DESCRIPTION	#	△ REF No.	PART No.	PART NAME, DESCRIPTION
C2218		QEKJ1HM-474	E CAPACITOR 0.47μF,50V	C4003		NCB21HK-102X	CAPACITOR 0.001μF,50V
C2219		QEKJ1CM-106	E CAPACITOR 10μF,16V	C4004		NBE20JM-226X	T CAPACITOR 22μF,6.3V
C2220		QEKJ1EM-475	E CAPACITOR 4.7μF,25V	C4006		NBE40JM-476X	T CAPACITOR 47μF,6.3V
C2221		NCB21HK-103X	CAPACITOR 0.01μF,50V	C4007		NCB21HK-102X	CAPACITOR 0.001μF,50V
C2222		QEKJ1HM-474	E CAPACITOR 0.47μF,50V	C4008		NCB21AK-105X	CAPACITOR 1μF,10V
C2223		QEKJ1HM-474	E CAPACITOR 0.47μF,50V	C4009		NCB21HK-563X	CAPACITOR 0.056μF,50V
C2224		NCB21HK-103X	CAPACITOR 0.01μF,50V	C4010		NCB21EK-223X	CAPACITOR 0.022μF,25V
C2225		QEKJ1EM-475	E CAPACITOR 4.7μF,25V	C4011		NCB21EK-104X	CAPACITOR 0.1μF,25V
C2226		QEKJ1CM-106	E CAPACITOR 10μF,16V	C4012		NCB21EK-224X	CAPACITOR 0.22μF,25V
C2227		NCB21CK-104X	CAPACITOR 0.1μF,16V	C4013		NCB21HK-563X	CAPACITOR 0.056μF,50V
C2228		NCB21CK-104X	CAPACITOR 0.1μF,16V	C4014		NDC21HJ-101X	CAPACITOR 100pF,50V
C2229		NDC21HJ-101X	CAPACITOR 100pF,50V	C4015		NDC21HJ-331X	CAPACITOR 330pF,50V
C2230		NDC21HJ-101X	CAPACITOR 100pF,50V	C4016		NDC21HJ-681X	CAPACITOR 680pF,50V
C2251		QEKJ1CM-476	E CAPACITOR 47μF,16V	C4017		NCB21HK-222X	CAPACITOR 0.0022μF,50V
C2252		NCB21HK-103X	CAPACITOR 0.01μF,50V	△ C5001		QFZ9073-683	F CAPACITOR 0.068μF,250V
C2253		NCB21CK-104X	CAPACITOR 0.1μF,16V	△ C5002		QFZ9051-333	F CAPACITOR 0.033μF,250V
C2254		NCB21CK-104X	CAPACITOR 0.1μF,16V	△ C5004		QCZ9071-222	CAPACITOR 0.0022μF,250V
C2255		NDC21HJ-181X	CAPACITOR 180pF,50V	C5006		QEZO375-686	E CAPACITOR 68μF,400V
C2501		QERF0JM-107	E CAPACITOR,S9700MS 100μF,6.3V	C5101		QCZO212-472	CAPACITOR 0.0047μF,1kV
C2502		NCB21HK-562X	CAPACITOR,S9700MS 0.0056μF,50V	C5102		QEMU1VM-276	E CAPACITOR 27μF,35V
C2503		QERF1HM-105	E CAPACITOR,S9700MS 1μF,50V	C5103		QCZO302-330Z	CAPACITOR 33pF,1kV
C2505		QEKJ0JM-107	E CAPACITOR,S9700MS 100μF,6.3V	C5104		QFLC1HJ-471Z	F CAPACITOR 470pF,50V
C2506		NCB21HK-103X	CAPACITOR,S9700MS 0.01μF,50V	C5201		QEMU0JM-227	E CAPACITOR 220μF,6.3V
C2507		QERF1CM-226	E CAPACITOR,S9700MS 22μF,16V	C5202		QEMT1CM-827	E CAPACITOR 820μF,16V
C2508		NCB21HK-103X	CAPACITOR,S9700MS 0.01μF,50V	C5203		QEMT1AM-228	E CAPACITOR 2200μF,10V
C2509		QERF1CM-106	E CAPACITOR,S9700MS 10μF,16V	C5204		QETN2AM-475	E CAPACITOR 4.7μF,100V
C2510		QEKJ1CM-476	E CAPACITOR,S9700MS 47μF,16V	C5205		QETN1HM-106	E CAPACITOR 10μF,50V
C2511		NCB21HK-222X	CAPACITOR,S9700MS 0.0022μF,50V	C5206		QEMU1EM-187	E CAPACITOR 180μF,25V
C2512		NDC21HJ-331X	CAPACITOR,S9700MS 330pF,50V	C5207		QETN1CM-227	E CAPACITOR 220μF,16V
C2513		NCB21HK-103X	CAPACITOR,S9700MS 0.01μF,50V	C5208		QETN1AM-227	E CAPACITOR 220μF,10V
C2518		NCB21HK-102X	CAPACITOR,S9700MS 0.001μF,50V	C5212		QEMU1VM-127	E CAPACITOR 120μF,35V
C2519		NCB21HK-103X	CAPACITOR,S9700MS 0.01μF,50V	C5213		QEMU0JM-227	E CAPACITOR 220μF,6.3V
C2520		NCB21HK-103X	CAPACITOR,S9700MS 0.01μF,50V	C5301		QETM0JM-108	E CAPACITOR 1000μF,6.3V
C3001		NCB21EK-104X	CAPACITOR 0.1μF,25V	C5303		QETN1CM-107	E CAPACITOR 100μF,16V
C3002		NCB21HK-103X	CAPACITOR 0.01μF,50V	C5304		QFVF1HJ-274Z	F CAPACITOR 0.27μF,50V
C3003		QEKJ1CM-106	E CAPACITOR 10μF,16V	C5305		NCB21HK-103X	CAPACITOR 0.01μF,50V
C3004		NCB21EK-104X	CAPACITOR 0.1μF,25V	C5306		QEKJ0JM-107	E CAPACITOR 100μF,6.3V
C3008		NCB21HK-102X	CAPACITOR 0.001μF,50V	C5307		QEKJ0JM-476	E CAPACITOR 47μF,6.3V
C3010		QEZO244-229	EDL CAPACITOR 0.0022F,5.5V	C5308		QETN1CM-107	E CAPACITOR 100μF,16V
C3012		QEKJ0JM-107	E CAPACITOR 100μF,6.3V	C5309		QETN1CM-107	E CAPACITOR 100μF,16V
C3015		NCB21EK-104X	CAPACITOR 0.1μF,25V	C6006		NCB21HK-103X	CAPACITOR 0.01μF,50V
C3016		NCB21EK-104X	CAPACITOR 0.1μF,25V	C6007		QEMU0JM-227	E CAPACITOR 220μF,6.3V
C3022		NCB21EK-104X	CAPACITOR 0.1μF,25V	C6008		NCB21HK-103X	CAPACITOR 0.01μF,50V
C3024		NDC21HJ-120X	CAPACITOR 12pF,50V	C6014		NCB21HK-103X	CAPACITOR 0.01μF,50V
C3026		NCB21HK-103X	CAPACITOR 0.01μF,50V	C6016		NCB21HK-103X	CAPACITOR 0.01μF,50V
C3027		NBE20JM-106X	T CAPACITOR 10μF,6.3V	C6023		NCB21HK-103X	CAPACITOR 0.01μF,50V
C3030		NBE20JM-226X	T CAPACITOR 22μF,6.3V	C6027		NDC21HJ-221X	CAPACITOR 220pF,50V
C3031		NCB21EK-104X	CAPACITOR 0.1μF,25V	C6028		NDC21HJ-221X	CAPACITOR 220pF,50V
C3032		NCB21EK-104X	CAPACITOR 0.1μF,25V	C6033		NRSA02J-0R0X	MG RESISTOR 0Ω,1/10W
C3033		NCB21EK-104X	CAPACITOR 0.1μF,25V	C6037		NBE20JM-106X	T CAPACITOR 10μF,6.3V
C3036		NDC21HJ-180X	CAPACITOR 18pF,50V	C6553		QEKJ0JM-107	E CAPACITOR 100μF,6.3V
C3037		NDC21HJ-120X	CAPACITOR 12pF,50V	C6555		NDC21HJ-1R0X	CAPACITOR 1pF,50V
C3040		QDYB1CM-103Y	CAPACITOR 0.01μF,16V	C7202		QETJ0JM-477	E CAPACITOR 470μF,6.3V
C3041		NDC21HJ-100X	CAPACITOR 10pF,50V	C7251		NRSA02J-0R0X	MG RESISTOR 0Ω,1/10W
C3042		QETJ0JM-477	E CAPACITOR 470μF,6.3V	L1		QQL29BJ-100Z	COIL 10μH
C3501		NCB21EK-104X	CAPACITOR,S9700MS 0.1μF,25V	L3		QQL29BJ-100Z	COIL 10μH
C3502		QEKJ1CM-106	E CAPACITOR,S9700MS 10μF,16V	L4		QQL29BJ-100Z	COIL 10μH
C3503		NCB21HK-103X	CAPACITOR,S9700MS 0.01μF,50V	L5		QQR0657-019Z	NOISE FILTER
C3602		NCB21EK-104X	CAPACITOR 0.1μF,25V	L12		QQR0967-001	COIL 12μH
C3652		NCB21EK-104X	CAPACITOR 0.1μF,25V	L13		QQL071J-330Y	COIL 33μH
C4002		NCB21EK-104X	CAPACITOR 0.1μF,25V	L14		QQL071J-101Y	COIL 100μH

#	△	REF No.	PART No.	PART NAME, DESCRIPTION	
L15			QQL29BJ-100Z	COIL	10μH
L17			QQL071J-5R6Y	COIL	5.6μH
L18			QQL071J-220Y	COIL	22μH
L19			QQL071J-120Y	COIL	12μH
L20			QQL071J-680Y	COIL	68μH
L24			QQL071J-270Y	COIL	27μH
L25			QQL29BJ-100Z	COIL	10μH
L27			QQL071J-330Y	COIL	33μH
L28			QQL071J-680Y	COIL	68μH
L401			QQL071J-150Y	COIL	15μH
L2251			QQL29BJ-100Z	COIL	10μH
L2252			QQL29BJ-151Z	COIL	150μH
L2501			QQL29BJ-2R2Z	COIL,S9700MS	2.2μH
L5201			PELN1184	COIL	33μH
L5202			PU60944-330K	COIL	33μH
L6001			QQL29BJ-100Z	COIL	10μH
L6002			QQL29BJ-100Z	COIL	10μH
L6005			QQL29BJ-100Z	COIL	10μH
L6031			NRSA02J-0R0X	MG RESISTOR	0Ω,1/10W
L7201			QQL01BJ-101Z	COIL	100μH
LPF2501			PELN1137	LOW PASS FILTER,S9700MS	
CF2501			QAX0399-001Z	RESONATOR,S9700MS	
LC2501			QQL29BJ-100Z	COIL,S9700MS	10μH
X1			QAX0576-001	CRYSTAL RESONATOR	
X2			QCBB1HK-103	CAPACITOR	0.01μF,50V
X3001			QAX0444-001	CRYSTAL RESONATOR	
X3002			QAX0527-001	CRYSTAL RESONATOR	
S3002			QSW0695-001	PUSH SWITCH,S CASS SW	
K2251			NRSA02J-0R0X	MG RESISTOR	0Ω,1/10W
K2252			NRSA02J-0R0X	MG RESISTOR	0Ω,1/10W
K2253			NRSA02J-0R0X	MG RESISTOR	0Ω,1/10W
K5101			QQR0678-001Z	FERRITE BEAD	
K5102			QQR0678-001Z	FERRITE BEAD	
K5201			QQR0678-001Z	FERRITE BEAD	
PC3001			GP3S123	IC(PHOTO SENSOR)	
PC3002			GP3S123	IC(PHOTO SENSOR)	
△ PC5101			PC123F2	PH COUPLER	
T2051			PELN0860	OSC TRANSFORMER	
T2052			PELN0861	OSC TRANSFORMER	
△ T5001			QQS0057-001	SW TRANSFORMER	
TU6001			QAU0152-001	TUNER	
ET1			PQ21623-1-5	EARTH PLATE(RF)	
ET2			LP40658-001B	EARTH PLATE(1)	
HS1			LP40621-001A	HEAT SINK,IC5101	
HS2			LP40479-001B	HEAT SINK,IC5301	
HS3			LP40515-001B	HEAT SINK,D5202,6,S9700MS	
SD1			LP30720-001A	SHIELD CASE(PRE/REC)	
WR13			QUB371-26A4ZA	SIN TWIST WIRE,WR13-WR11	
WR14			QUB372-09A4ZA	SIN TWIST WIRE,WR14-WR15	
WR101			QRE141J-0R0	RESISTOR,M/I	0Ω,1/4W
WR5301			QUB371-38ZAZA	SHIN TWIST WIRE,S9700MS	
OT1			PU59915-107	#500SPACER0.007,WR13	
OT2			PU59915-107	#500SPACER0.007,WR13	
OT3			PU59915-107	#500SPACER0.007,WR14	
OT4			PU59915-105	#500SPACER0.01,C45	
OT5			PU59915-107	#500SPACER0.007,WR5301,S9700MS	
OT6			QYTDSF3010Z	SCREW,X2	
OT7			QYTDST3008Z	SCREW,IC5101	
OT8			QYTDST3006Z	SCREW,IC5301	
OT9			QYTDST3008Z	SCREW,D5202,6,S9700MS	
FC5001			QNG0006-001Z	FUSE CLIP,F5001	

#	△	REF No.	PART No.	PART NAME, DESCRIPTION	
FC5002			QNG0006-001Z	FUSE CLIP,F5001	
△ LF5001			PELN1204-01-01	LINE FILTER	
△ LF5002			QQR0608-001	LINE FILTER	
CN1			QGF1028C1-13	FPC CONNECTOR,(4-16)U.DRUM	
CN901			QGF1207C1-04	FPC CONNECTOR,(1-4)FRONT S IN	
CN902			QGF1207C1-05	FPC CONNECTOR,(1-5)F_IN	
CN903			QGB2024K1-12S	CONNECTOR,(1-12)TERMINAL	
CN904			QGB2024K1-12S	CONNECTOR,(1-12)TERMINAL	
CN905			QGB2024K1-05S	CONNECTOR,(1-5)TERMINAL	
CN907			QGB2024K1-10S	CONNECTOR,(1-10)TERMINAL	
CN2001			QGF1207C1-07	FPC CONNECTOR,(1-7)A/C HEAD	
CN2002			QGB2532J1-02	CONNECTOR,(1-2)FE HEAD	
CN2051			QGB2024K1-04S	CONNECTOR,(1-4)AUDIO ERASE	
CN3001			QGF1207C1-05	FPC CONNECTOR,(1-5)DRUM MDA	
CN3002			QGB2532J1-02	CONNECTOR,(1-2)LOADING MOTOR	
CN3003			QGB2015M2-08	CONNECTOR,(1-8)CAPSTAN MOTOR	
CN3004			QGB2534J2-04	CONNECTOR,(1-4)ROTARY ENCODER	
CN3011			QGF1207C1-14	FPC CONNECTOR,(1-14)FRONT	
CN3012			QGF1207C1-06	FPC CONNECTOR,(1-6)JOG,S8700MS	
CN3501			QGB2011L2-06	CONNECTOR,(1-6)DD MDA,S9700MS	
△ CN5001			QGA7901C3-02	CONNECTOR,(1-2)AC IN	
CN6102			QGF1207C1-04	FPC CONNECTOR,(5-8)BS/PS,S8700MS	
			QGF1207C1-10	FPC CONNECTOR,(1-10)BS/PS,S9700MS	
△ CP4001			ICP-N25	CIRCUIT PROTECTOR	
△ CP5301			ICP-N38	CIRCUIT PROTECTOR	
△ CP5302			ICP-N25	CIRCUIT PROTECTOR	
△ F5001			QMF51E2-2R0J1	FUSE	T2.0A,AC250V

3D DIGITAL/2M BOARD ASSEMBLY <05>

PW1	LPA10105-01C	3D DIGITAL/2M BOARD ASSY
IC1401	JCP8026	IC
Q1401	2SC1317/RS/-T	TRANSISTOR
Q1402	2SA1576A/QR/-X	TRANSISTOR
	or 2PA1576/R/-X	TRANSISTOR
Q1403	2SA1576A/QR/-X	TRANSISTOR
	or 2PA1576/R/-X	TRANSISTOR
Q1404	DTC144WU	TRANSISTOR
	or RN1309	TRANSISTOR
	or UN521E	TRANSISTOR
Q1406	2SA1576A/QR/-X	TRANSISTOR
	or 2PA1576/R/-X	TRANSISTOR
Q1407	2SA1576A/QR/-X	TRANSISTOR
	or 2PA1576/R/-X	TRANSISTOR
Q1408	2SC4081/S/-X	TRANSISTOR
Q1410	2SC4081/QRS/-X	TRANSISTOR
	or 2PC4081/R/-X	TRANSISTOR
Q1412	2SC4081/QRS/-X	TRANSISTOR
	or 2PC4081/R/-X	TRANSISTOR
Q1413	2SA1576A/QR/-X	TRANSISTOR
	or 2PA1576/R/-X	TRANSISTOR
Q1414	DTC144WU	TRANSISTOR
	or RN1309	TRANSISTOR
	or UN521E	TRANSISTOR
Q1417	2SC4081/QRS/-X	TRANSISTOR
	or 2PC4081/R/-X	TRANSISTOR

#	△ REF No.	PART No.	PART NAME, DESCRIPTION	#	△ REF No.	PART No.	PART NAME, DESCRIPTION
Q1418		2SA1576A/QR/-X or 2PA1576/R/-X	TRANSISTOR	C1406		NCB21HK-103X	CAPACITOR 0.01μF,50V
Q1419		DTC124TU	TRANSISTOR	C1407		NDC21HJ-680X	CAPACITOR 68pF,50V
Q1420		2SC4081/QRS/-X or 2PC4081/R/-X	TRANSISTOR	C1408		NDC21HJ-330X	CAPACITOR 33pF,50V
D1401		RD4.3ES/B2/-T2 or MTZJ4.3B	ZENER DIODE	C1410		QEKJ1EM-475	E CAPACITOR 4.7μF,25V
D1402		1SS133 or 1N4148M	DIODE	C1411		NCF21EZ-104X	CAPACITOR 0.1μF,25V
R1401		NRSA02J-181X	MG RESISTOR 180Ω,1/10W	C1412		NDC21HJ-680X	CAPACITOR 68pF,50V
R1402		NRSA02J-101X	MG RESISTOR 100Ω,1/10W	C1413		NDC21HJ-330X	CAPACITOR 33pF,50V
R1404		NRSA02J-182X	MG RESISTOR 1.8kΩ,1/10W	C1415		NCF21EZ-104X	CAPACITOR 0.1μF,25V
R1406		NRSA02J-471X	MG RESISTOR 470Ω,1/10W	C1416		QEKJ1CM-106	E CAPACITOR 10μF,16V
R1407		NRSA02J-272X	MG RESISTOR 2.7kΩ,1/10W	C1417		NCF21EZ-104X	CAPACITOR 0.1μF,25V
R1408		NRSA02J-122X	MG RESISTOR 1.2kΩ,1/10W	C1421		NDC21HJ-330X	CAPACITOR 33pF,50V
R1410		NRSA02J-391X	MG RESISTOR 390Ω,1/10W	C1422		NDC21HJ-680X	CAPACITOR 68pF,50V
R1411		NRSA02J-152X	MG RESISTOR 1.5kΩ,1/10W	C1423		NCF21EZ-104X	CAPACITOR 0.1μF,25V
R1413		NRSA02J-331X	MG RESISTOR 330Ω,1/10W	C1424		NCB21HK-103X	CAPACITOR 0.01μF,50V
R1414		NRSA02J-821X	MG RESISTOR 820Ω,1/10W	C1425		NCB21HK-103X	CAPACITOR 0.01μF,50V
R1415		NRSA02J-221X	MG RESISTOR 220Ω,1/10W	C1426		NDC21HJ-390X	CAPACITOR 39pF,50V
R1416		NRSA02J-104X	MG RESISTOR 100kΩ,1/10W	C1428		NDC21HJ-220X	CAPACITOR 22pF,50V
R1417		NRSA02J-101X	MG RESISTOR 100Ω,1/10W	C1429		QEKJ0JM-337	E CAPACITOR 330μF,6.3V
R1418		NRSA02J-471X	MG RESISTOR 470Ω,1/10W	C1430		NCF21EZ-104X	CAPACITOR 0.1μF,25V
R1421		NRSA02J-391X	MG RESISTOR 390Ω,1/10W	C1432		NCF21CZ-105X	CAPACITOR 1μF,16V
R1426		NRSA02J-561X	MG RESISTOR 560Ω,1/10W	C1433		NCF21EZ-104X	CAPACITOR 0.1μF,25V
R1427		NRSA02J-333X	MG RESISTOR 33kΩ,1/10W	C1435		NCF21EZ-104X	CAPACITOR 0.1μF,25V
R1428		NRSA02J-393X	MG RESISTOR 39kΩ,1/10W	C1436		NCF21EZ-104X	CAPACITOR 0.1μF,25V
R1429		NRSA02J-152X	MG RESISTOR 1.5kΩ,1/10W	C1437		NCF21EZ-104X	CAPACITOR 0.1μF,25V
R1430		NRSA02J-222X	MG RESISTOR 2.2kΩ,1/10W	C1438		NCF21EZ-104X	CAPACITOR 0.1μF,25V
R1431		NRSA02J-821X	MG RESISTOR 820Ω,1/10W	C1439		NCF21CZ-105X	CAPACITOR 1μF,16V
R1432		NRSA02J-182X	MG RESISTOR 1.8kΩ,1/10W	C1440		NCF21EZ-104X	CAPACITOR 0.1μF,25V
R1433		NRSA02J-510X	MG RESISTOR 51Ω,1/10W	C1441		NCF21EZ-104X	CAPACITOR 0.1μF,25V
R1434		NRSA02J-153X	MG RESISTOR 15kΩ,1/10W	C1442		NCF21CZ-105X	CAPACITOR 1μF,16V
R1435		NRSA02J-223X	MG RESISTOR 22kΩ,1/10W	C1444		NCF21EZ-104X	CAPACITOR 0.1μF,25V
R1436		NRSA02J-682X	MG RESISTOR 6.8kΩ,1/10W	C1445		NCF21EZ-104X	CAPACITOR 0.1μF,25V
R1437		NRSA02J-392X	MG RESISTOR 3.9kΩ,1/10W	C1446		QEKJ0JM-107	E CAPACITOR 100μF,6.3V
R1438		NRSA02J-473X	MG RESISTOR 47kΩ,1/10W	C1447		NCF21EZ-104X	CAPACITOR 0.1μF,25V
R1439		NRSA02J-273X	MG RESISTOR 27kΩ,1/10W	C1448		QEKJ0JM-337	E CAPACITOR 330μF,6.3V
R1440		NRSA02J-473X	MG RESISTOR 47kΩ,1/10W	C1449		NCF21EZ-104X	CAPACITOR 0.1μF,25V
R1441		NRSA02J-682X	MG RESISTOR 6.8kΩ,1/10W	C1450		NCF21EZ-104X	CAPACITOR 0.1μF,25V
R1442		NRSA02J-682X	MG RESISTOR 6.8kΩ,1/10W	C1451		QEKJ1EM-475	E CAPACITOR 4.7μF,25V
R1446		NRSA02J-102X	MG RESISTOR 1kΩ,1/10W	C1452		NCF21EZ-104X	CAPACITOR 0.1μF,25V
R1447		NRSA02J-102X	MG RESISTOR 1kΩ,1/10W	C1453		NCF21EZ-104X	CAPACITOR 0.1μF,25V
R1448		NRSA02J-102X	MG RESISTOR 1kΩ,1/10W	C1454		NCF21EZ-104X	CAPACITOR 0.1μF,25V
R1449		NRSA02J-102X	MG RESISTOR 1kΩ,1/10W	C1455		NCF21EZ-104X	CAPACITOR 0.1μF,25V
R1450		NRSA02J-102X	MG RESISTOR 1kΩ,1/10W	C1459		NDC21HJ-470X	CAPACITOR 47pF,50V
R1452		NRSA02J-471X	MG RESISTOR 470Ω,1/10W	C1460		NDC21HJ-470X	CAPACITOR 47pF,50V
R1453		NRSA02J-102X	MG RESISTOR 1kΩ,1/10W	C1461		NDC21HJ-470X	CAPACITOR 47pF,50V
R1454		NRSA02J-102X	MG RESISTOR 1kΩ,1/10W	C1462		NDC21HJ-470X	CAPACITOR 47pF,50V
R1455		NRSA02J-681X	MG RESISTOR 680Ω,1/10W	C1463		QEKJ0JM-336	E CAPACITOR 33μF,6.3V
R1458		NRSA02J-681X	MG RESISTOR 680Ω,1/10W	C1465		NDC21HJ-470X	CAPACITOR 47pF,50V
R1459		NRSA02J-681X	MG RESISTOR 680Ω,1/10W	C1466		NDC21HJ-470X	CAPACITOR 47pF,50V
R1460		NRSA02J-273X	MG RESISTOR 27kΩ,1/10W	C1467		NDC21HJ-470X	CAPACITOR 47pF,50V
R1461		NRSA02J-121X	MG RESISTOR 120Ω,1/10W	C1468		NDC21HJ-101X	CAPACITOR 100pF,50V
R1463		NRSA02J-101X	MG RESISTOR 100Ω,1/10W	C1470		NDC21HJ-330X	CAPACITOR 33pF,50V
VR1401		QVZ3521-103Z	V RESISTOR,D/A LEVEL ADJ	C1471		NCF21EZ-104X	CAPACITOR 0.1μF,25V
C1401		QEKJ1CM-336	E CAPACITOR 33μF,16V	C1472		NCF21EZ-104X	CAPACITOR 0.1μF,25V
C1402		NCB21HK-103X	CAPACITOR 0.01μF,50V	C1473		NCF21EZ-104X	CAPACITOR 0.1μF,25V
C1403		QEKJ0JM-337	E CAPACITOR 330μF,6.3V	L1401		QQL29BJ-100Z	COIL 10μH
C1404		NCF21EZ-104X	CAPACITOR 0.1μF,25V	L1402		QQL071J-6R8Y	COIL 6.8μH
C1405		NCF21EZ-104X	CAPACITOR 0.1μF,25V	L1403		QQL071J-6R8Y	COIL 6.8μH
				L1404		QQL071J-6R8Y	COIL 6.8μH
				L1405		QQL29BJ-100Z	COIL 10μH
				L1406		QQL071J-330Y	COIL 33μH
				L1407		QQL29BJ-100Z	COIL 10μH

#	△ REF No.	PART No.	PART NAME, DESCRIPTION	
L1409	QQL071J-1R0Y	COIL	1μH	
LC1401	QQR0657-013Z	NOISE FILTER		
LC1402	QQR0657-010Z	NOISE FILTER		
SD1	LP30706-001B	SHIELD FRAME(S VHS)		
SD2	LP30684-001A	SHIELD CASE(S VHS)		
CN1401	QGG2502K1-17	HEADER PIN,(1-7)MAIN		

TERMINAL BOARD ASSEMBLY <06>

PW1	LPA10100-08A	TERMINAL BOARD ASSY,S8700MS		
	LPA10100-09A	TERMINAL BOARD ASSY,S9700MS		
IC201	LC74775-9750	IC		
IC901	BH7636S	IC		
Q207	2SB1218A/QR/-X	TRANSISTOR		
	or 2SA1576A/QR/-X	TRANSISTOR		
	or 2PA1576/R/-X	TRANSISTOR		
Q901	UN5211	TRANSISTOR		
	or RN1302	TRANSISTOR		
	or DTC114EU	TRANSISTOR		
	or PDTC114EU	TRANSISTOR		
Q902	2SB1218A/QR/-X	TRANSISTOR		
	or 2SA1576A/QR/-X	TRANSISTOR		
	or 2PA1576/R/-X	TRANSISTOR		
Q903	2SB1218A/QR/-X	TRANSISTOR		
	or 2SA1576A/QR/-X	TRANSISTOR		
	or 2PA1576/R/-X	TRANSISTOR		
Q904	2SB1218A/QR/-X	TRANSISTOR		
	or 2PA1576/R/-X	TRANSISTOR		
	or 2SA1576A/QR/-X	TRANSISTOR		
Q905	2SD1819A/QRS/-X	TRANSISTOR		
	or 2SC4081/QRS/-X	TRANSISTOR		
	or 2PC4081/R/-X	TRANSISTOR		
Q906	2SD1819A/QRS/-X	TRANSISTOR		
	or 2PC4081/R/-X	TRANSISTOR		
	or 2SC4081/QRS/-X	TRANSISTOR		
Q907	2SD1819A/QRS/-X	TRANSISTOR		
	or 2SC4081/QRS/-X	TRANSISTOR		
	or 2PC4081/R/-X	TRANSISTOR		
Q908	2SB1218A/QR/-X	TRANSISTOR		
	or 2PA1576/R/-X	TRANSISTOR		
	or 2SA1576A/QR/-X	TRANSISTOR		
Q909	2SB1218A/QR/-X	TRANSISTOR		
	or 2SA1576A/QR/-X	TRANSISTOR		
	or 2PA1576/R/-X	TRANSISTOR		
Q911	UN521E	TRANSISTOR		
	or RN1309	TRANSISTOR		
	or DTC144WU	TRANSISTOR		
	or PDTC144WU	TRANSISTOR		
Q912	UN5215	TRANSISTOR		
	or RN1311	TRANSISTOR		
	or DTC114TU	TRANSISTOR		
	or PDTC114TU	TRANSISTOR		
D201	QRE141J-152Y	RESISTOR	1.5kΩ,1/4W	
D205	1SS133	DIODE		
R202	NRSA02J-103X	MG RESISTOR	10kΩ,1/10W	
R208	NRSA02J-222X	MG RESISTOR	2.2kΩ,1/10W	

#	△ REF No.	PART No.	PART NAME, DESCRIPTION	
R209	NRSA02J-512X	MG RESISTOR	5.1kΩ,1/10W	
R210	NRSA02J-182X	MG RESISTOR	1.8kΩ,1/10W	
R211	NRSA02J-562X	MG RESISTOR	5.6kΩ,1/10W	
R212	NRSA02J-101X	MG RESISTOR	100Ω,1/10W	
R213	NRSA02J-0R0X	MG RESISTOR	0Ω,1/10W	
R214	NRSA02J-103X	MG RESISTOR	10kΩ,1/10W	
R216	NRSA02J-103X	MG RESISTOR	10kΩ,1/10W	
R218	NRSA02J-331X	MG RESISTOR	330Ω,1/10W	
R901	NRSA02J-750X	MG RESISTOR	75Ω,1/10W	
R902	NRSA02J-750X	MG RESISTOR	75Ω,1/10W	
R903	NRSA02J-680X	MG RESISTOR	68Ω,1/10W	
R904	NRSA02J-101X	MG RESISTOR	100Ω,1/10W	
R905	NRSA02J-101X	MG RESISTOR	100Ω,1/10W	
R906	NQL402M-100X	COIL	10μH	
R907	NQL402M-100X	COIL	10μH	
R908	NRSA02J-0R0X	MG RESISTOR	0Ω,1/10W	
R909	NRSA02J-750X	MG RESISTOR	75Ω,1/10W	
R910	NRSA02J-750X	MG RESISTOR	75Ω,1/10W	
R911	NRSA02J-750X	MG RESISTOR	75Ω,1/10W	
R912	NRSA02J-101X	MG RESISTOR	100Ω,1/10W	
R913	NRSA02J-101X	MG RESISTOR	100Ω,1/10W	
R914	NQL402M-100X	COIL	10μH	
R915	NQL402M-100X	COIL	10μH	
R916	NRSA02J-102X	MG RESISTOR	1kΩ,1/10W	
R917	NRSA02J-0R0X	MG RESISTOR	0Ω,1/10W	
R918	NRSA02J-0R0X	MG RESISTOR	0Ω,1/10W	
R919	NRSA02J-101X	MG RESISTOR	100Ω,1/10W	
R920	NRSA02J-0R0X	MG RESISTOR	0Ω,1/10W	
R921	QRE123J-391X	RESISTOR	390Ω,1/2W	
R922	QRE123J-391X	RESISTOR	390Ω,1/2W	
R923	NRSA02J-750X	MG RESISTOR	75Ω,1/10W	
R924	NRSA02J-750X	MG RESISTOR	75Ω,1/10W	
R931	NRSA02J-101X	MG RESISTOR	100Ω,1/10W	
R932	NRSA02J-511X	MG RESISTOR	510Ω,1/10W	
R933	NRSA02J-471X	MG RESISTOR	470Ω,1/10W	
R934	NRSA02J-101X	MG RESISTOR	100Ω,1/10W	
R935	QRE141J-101Y	RESISTOR	100Ω,1/4W	
R936	NRSA02J-101X	MG RESISTOR	100Ω,1/10W	
R937	QRE141J-101Y	RESISTOR	100Ω,1/4W	
R938	QRE141J-101Y	RESISTOR	100Ω,1/4W	
R939	QRE141J-101Y	RESISTOR	100Ω,1/4W	
R940	NRSA02J-103X	MG RESISTOR	10kΩ,1/10W	
R941	NRSA02J-332X	MG RESISTOR	3.3kΩ,1/10W	
R942	NRSA02J-472X	MG RESISTOR	4.7kΩ,1/10W	
R943	NRSA02J-0R0X	MG RESISTOR	0Ω,1/10W	
R944	NRSA02J-272X	MG RESISTOR	2.7kΩ,1/10W	
R945	NRSA02J-102X	MG RESISTOR	1kΩ,1/10W	
R946	NRSA02J-561X	MG RESISTOR	560Ω,1/10W	
R947	NRSA02J-682X	MG RESISTOR	6.8kΩ,1/10W	
R949	QRE123J-331X	RESISTOR	330Ω,1/2W	
R951	NRSA02J-332X	MG RESISTOR	3.3kΩ,1/10W	
R952	NRSA02J-562X	MG RESISTOR	5.6kΩ,1/10W	
R953	NRSA02J-562X	MG RESISTOR	5.6kΩ,1/10W	
R964	NRSA02J-101X	MG RESISTOR	100Ω,1/10W	
R965	NRSA02J-101X	MG RESISTOR	100Ω,1/10W	
C201	QEKJ0JM-227	E CAPACITOR	220μF,6.3V	
C204	NDC21HJ-100X	CAPACITOR	10pF,50V	
C206	NDC21HJ-330X	CAPACITOR	33pF,50V	
C207	NDC21HJ-330X	CAPACITOR	33pF,50V	
C209	NCB21CK-474X	CAPACITOR	0.47μF,16V	
C210	NDC21HJ-101X	CAPACITOR	100pF,50V	

#	△ REF No.	PART No.	PART NAME, DESCRIPTION
C211		NDC21HJ-101X	CAPACITOR 100pF,50V
C212		NCB21EK-104X	CAPACITOR 0.1μF,25V
C213		QEKJ1EM-475	E CAPACITOR 4.7μF,25V
C214		NCB21CK-224X	CAPACITOR 0.22μF,16V
C215		NCB21CK-224X	CAPACITOR 0.22μF,16V
C216		QEKJ0JM-227	E CAPACITOR 220μF,6.3V
C217		NDC21HJ-560X	CAPACITOR 56pF,50V
C218		NCB21AK-105X	CAPACITOR 1μF,10V
C222		NCB21AK-105X	CAPACITOR 1μF,10V
C225		NCB21EK-104X	CAPACITOR 0.1μF,25V
C901		NCB21HK-331X	CAPACITOR 330pF,50V
C902		NCB21HK-331X	CAPACITOR 330pF,50V
C903		NCB21HK-471X	CAPACITOR 470pF,50V
C904		NCB21HK-471X	CAPACITOR 470pF,50V
C905		NCB21HK-331X	CAPACITOR 330pF,50V
C906		NCB21HK-331X	CAPACITOR 330pF,50V
C907		NCB21HK-471X	CAPACITOR 470pF,50V
C908		NCB21HK-471X	CAPACITOR 470pF,50V
C910		NCB21HK-102X	CAPACITOR 0.001μF,50V
C912		NCB21HK-102X	CAPACITOR 0.001μF,50V
C913		NCB21HK-103X	CAPACITOR 0.01μF,50V
C914		NCB21HK-103X	CAPACITOR 0.01μF,50V
C915		NCB21HK-103X	CAPACITOR 0.01μF,50V
C916		NCB21HK-223X	CAPACITOR 0.022μF,50V
C917		NCB21HK-223X	CAPACITOR 0.022μF,50V
C918		NCB21HK-223X	CAPACITOR 0.022μF,50V
C921		NDC21HJ-330X	CAPACITOR 33pF,50V
C923		QEKJ1CM-476	E CAPACITOR 47μF,16V
C924		NCB21HK-103X	CAPACITOR 0.01μF,50V
C925		NCB21HK-223X	CAPACITOR 0.022μF,50V
C927		QEKJ1CM-476	E CAPACITOR 47μF,16V
C930		NCB21HK-103X	CAPACITOR 0.01μF,50V
C931		QEKJ1CM-476	E CAPACITOR 47μF,16V
C933		NCB21HK-331X	CAPACITOR 330pF,50V
C934		NCB21HK-331X	CAPACITOR 330pF,50V
C935		NCB21HK-471X	CAPACITOR 470pF,50V
C936		NCB21HK-471X	CAPACITOR 470pF,50V
C937		NCB21HK-331X	CAPACITOR 330pF,50V
C938		NCB21HK-331X	CAPACITOR 330pF,50V
C939		NCB21HK-471X	CAPACITOR 470pF,50V
C940		NCB21HK-471X	CAPACITOR 470pF,50V
C941		QETJ0JM-477	E CAPACITOR 470μF,6.3V
C942		QEKJ1CM-476	E CAPACITOR 47μF,16V
C943		QEKJ1CM-476	E CAPACITOR 47μF,16V
C945		QEKJ1CM-106	E CAPACITOR 10μF,16V
C946		QEKJ1CM-106	E CAPACITOR 10μF,16V
C947		QETJ0JM-477	E CAPACITOR 470μF,6.3V
C951		QEKJ1CM-476	E CAPACITOR 47μF,16V
L201		QQL29BK-1R0Z	COIL 1μH
L202		QQL071J-330Y	COIL 33μH
L203		QQL071J-220Y	COIL 22μH
L204		QQL29BJ-100Z	COIL 10μH
L206		QQL071J-220Y	COIL 22μH
L901		QQL231J-R22Y	COIL 0.22μH
L902		QQL071J-1R0Y	COIL 1μH
L903		QQL071J-150Y	COIL 150μH
L904		QQL071J-150Y	COIL 150μH
L910		QQL071J-1R0Y	COIL 1μH
L913		QQL071J-4R7Y	COIL 4.7μH
L914		QQL071J-4R7Y	COIL 4.7μH
L915		QQL071J-4R7Y	COIL 4.7μH

#	△ REF No.	PART No.	PART NAME, DESCRIPTION
L916		QQL071J-4R7Y	COIL 4.7μH
L917		QQL071J-4R7Y	COIL 4.7μH
L918		QQL071J-4R7Y	COIL 4.7μH
L919		QQL071J-4R7Y	COIL 4.7μH
L920		QQL071J-4R7Y	COIL 4.7μH
ET1		PQ21987-1-1	EATH PLATE(TERMINAL)
J901		PEMC1177	RGB21PIN SOCKET,AV1 IN/OUT
J902		PEMC1177	RGB21PIN SOCKET,AV2/DECODER
J903		QND0084-001	S JACK,S_OUT,S8700MS
		QND0085-001	S JACK,S OUT,S9700MS
J912		QNN0021-003	PIN JACK,A.OUT(L),S9700MS
		QNN0023-003	PIN JACK,A.OUT(L),S8700MS
J913		QNN0021-002	PIN JACK,A.OUT(R),S9700MS
		QNN0023-002	PIN JACK,A.OUT(R),S8700MS
J923		PEMC1190	MINI JACK, JLIP
J924		QNS0150-001	2.5 JACK,LANC
J925		PU60659	MINI JACK,SAT.CTL
J926		PU60659	MINI JACK,R.PAUSE
△ TB1		LP30712-008B	TERMINAL BOARD ASSY,S9700MS
△ TB1		LP30712-009B	TERMINAL BOARD ASSY,S8700MS
OT1		QYTDSF3008Z	SCREW,X8
WR901		QUB320-07ZAZA	SIN TWIST WIRE
CN911		QGF1208F1-14	FPC CONNECTOR,(1-14)S-SUB
CN912		QGF1208F1-08	FPC CONNECTOR,(1-8)
CN913		QGB2024J1-12S	CONNECTOR,(1-12)MAIN
CN914		QGB2024J1-12S	CONNECTOR,(1-12)MAIN
CN915		QGB2024J1-05S	CONNECTOR,(1-5)MAIN
CN917		QGB2024J1-10S	CONNECTOR,(1-10)MAIN

AUDIO CONTROL HEAD BOARD ASSEMBLY <12>

PW1	LPA10010-01A1	A/C HEAD BOARD ASSY
CN1	QGF1208F1-07	FPC CONNECTOR

DEMOD BOARD ASSEMBLY <14>

PW1	LPA10094-01C	DEMOD BOARD ASSY
IC6701	MSP34VCDT	IC
	or MSP3417D	IC
Q6701	2SC3936/BC/-X	TRANSISTOR
D6701	1SS133	DIODE
	or 1N4148M	DIODE
R6701	NRSA02J-392X	MG RESISTOR 3.9kΩ,1/10W
R6702	NRSA02J-682X	MG RESISTOR 6.8kΩ,1/10W
R6703	NRSA02J-470X	MG RESISTOR 47Ω,1/10W
R6704	NRSA02J-102X	MG RESISTOR 1kΩ,1/10W
R6705	NRSA02J-271X	MG RESISTOR 270Ω,1/10W
R6706	NRSA02J-151X	MG RESISTOR 150Ω,1/10W
R6707	NRSA02J-220X	MG RESISTOR 22Ω,1/10W
R6708	NRSA02J-101X	MG RESISTOR 100Ω,1/10W
R6709	NRSA02J-101X	MG RESISTOR 100Ω,1/10W
R6710	NRSA02J-100X	MG RESISTOR 10Ω,1/10W
R6711	NRSA02J-684X	MG RESISTOR 680kΩ,1/10W
R6712	NRSA02J-102X	MG RESISTOR 1kΩ,1/10W
R6714	NRSA02J-102X	MG RESISTOR 1kΩ,1/10W

#	△	REF No.	PART No.	PART NAME, DESCRIPTION		#	△	REF No.	PART No.	PART NAME, DESCRIPTION	
R6716			NRSA02J-470X	MG RESISTOR	47Ω,1/10W	R531			NRSA02J-101X	MG RESISTOR	100Ω,1/10W
R6719			QRE141J-103Y	RESISTOR	10kΩ,1/4W	R532			NRSA02J-101X	MG RESISTOR	100Ω,1/10W
R6720			NRSA02J-562X	MG RESISTOR	5.6kΩ,1/10W	R533			NRSA02J-101X	MG RESISTOR	100Ω,1/10W
R6721			NRSA02J-562X	MG RESISTOR	5.6kΩ,1/10W	R534			NRSA02J-101X	MG RESISTOR	100Ω,1/10W
C6701			NCB21HK-103X	CAPACITOR	0.01μF,50V	R535			NRSA02J-101X	MG RESISTOR	100Ω,1/10W
C6702			NCB21HK-222X	CAPACITOR	0.0022μF,50V	R536			NRSA02J-101X	MG RESISTOR	100Ω,1/10W
C6704			NCB21HK-103X	CAPACITOR	0.01μF,50V	C501			QEKJ1HM-225	E CAPACITOR	2.2μF,50V
C6705			NCB21HK-102X	CAPACITOR	0.001μF,50V	C502			QEKJ1EM-475	E CAPACITOR	4.7μF,25V
C6707			NDC21HJ-470X	CAPACITOR	47pF,50V	C503			QEKJ1HM-225	E CAPACITOR	2.2μF,50V
C6708			NDC21HJ-8R0X	CAPACITOR	8pF,50V	C504			NCB21EK-104X	CAPACITOR	0.1μF,25V
C6709			NDC21HJ-1R0X	CAPACITOR	1pF,50V	C505			QEKJ1EM-475	E CAPACITOR	4.7μF,25V
C6713			NCF21CZ-224X	CAPACITOR	0.22μF,16V	C506			NCB21EK-104X	CAPACITOR	0.1μF,25V
C6714			NCB21HK-682X	CAPACITOR	0.0068μF,50V	C507			QEKJ0JM-227	E CAPACITOR	220μF,6.3V
C6715			QEKJ1HM-225	E CAPACITOR	2.2μF,50V	C508			QEPF1HM-474	NP E CAPACITOR	0.47μF,50V
C6716			NCB21HK-682X	CAPACITOR	0.0068μF,50V	C509			QEKJ1CM-106	E CAPACITOR	10μF,16V
C6717			QEKJ1HM-225	E CAPACITOR	2.2μF,50V	C510			QEKJ0JM-227	E CAPACITOR	220μF,6.3V
C6719			QEKJ1CM-106	E CAPACITOR	10μF,16V	C511			NCB21HK-103X	CAPACITOR	0.01μF,50V
C6720			QEKJ1CM-106	E CAPACITOR	10μF,16V	C512			NCB21HK-103X	CAPACITOR	0.01μF,50V
C6721			NCB21HK-103X	CAPACITOR	0.01μF,50V	C513			QEKJ1EM-475	E CAPACITOR	4.7μF,25V
C6723			NCB21HK-103X	CAPACITOR	0.01μF,50V	C514			NCB21HK-103X	CAPACITOR	0.01μF,50V
C6724			QEKJ1HM-225	E CAPACITOR	2.2μF,50V	C515			NCB21HK-103X	CAPACITOR	0.01μF,50V
L6701			QQL231J-1R0Y	COIL	1μH	C516			NCB21HK-103X	CAPACITOR	0.01μF,50V
L6702			QQL231J-3R3Y	COIL	3.3μH	C517			NCF21EZ-104X	CAPACITOR	0.1μF,25V
X6701			QAX0443-001	CRYSTAL RESONATOR		C518			NCB21EK-104X	CAPACITOR	0.1μF,25V
K6701			NQR0200-003X	FERRITE BEAD		C519			QEKJ1HM-225	E CAPACITOR	2.2μF,50V
K6702			NQR0200-003X	FERRITE BEAD		C520			QERF1EM-475	E CAPACITOR	4.7μF,25V
K6703			NQR0200-003X	FERRITE BEAD		C521			QEKJ1EM-475	E CAPACITOR	4.7μF,25V
K6704			NQR0200-003X	FERRITE BEAD		C522			QEKJ1HM-225	E CAPACITOR	2.2μF,50V
K6705			NQR0200-003X	FERRITE BEAD		C523			QEKJ1HM-225	E CAPACITOR	2.2μF,50V
K6706			NQR0200-003X	FERRITE BEAD		C524			NDC21HG-301X	CAPACITOR	300pF,50V
K6707			NQR0200-003X	FERRITE BEAD		C525			NDC21HG-301X	CAPACITOR	300pF,50V
BK1			LP40077-001A	BRACKET(BOARD)		C526			NDC21HJ-101X	CAPACITOR	100pF,50V
CN6701			QGG2502K1-10	HEADER PIN		C527			NDC21HJ-181X	CAPACITOR	180pF,50V
						C528			NDC21HG-271X	CAPACITOR	270pF,50V
						C529			NDC21HG-820X	CAPACITOR	82pF,50V
						C530			NDC21HG-221X	CAPACITOR	220pF,50V
						C531			NDC21HG-301X	CAPACITOR	300pF,50V
						C532			NDC21HG-301X	CAPACITOR	300pF,50V
						C533			NCB21HK-103X	CAPACITOR	0.01μF,50V
						C534			QETJ0JM-477	E CAPACITOR	470μF,6.3V
						C535			NCB21HK-103X	CAPACITOR	0.01μF,50V
						C551			QEKJ1HM-105	E CAPACITOR	1μF,50V
						C553			NCB21HK-103X	CAPACITOR	0.01μF,50V
						C554			QEKJ1HM-105	E CAPACITOR	1μF,50V
						C556			NCB21HK-103X	CAPACITOR	0.01μF,50V
						C557			QEKJ1HM-105	E CAPACITOR	1μF,50V
						C559			NCB21HK-103X	CAPACITOR	0.01μF,50V
						C560			QEKJ1HM-105	E CAPACITOR	1μF,50V
						C561			QEKJ1HM-105	E CAPACITOR	1μF,50V
						C562			QEKJ1HM-105	E CAPACITOR	1μF,50V
						C564			NCB21HK-103X	CAPACITOR	0.01μF,50V
						C566			NCB21HK-103X	CAPACITOR	0.01μF,50V
						C568			NDC21HJ-680X	CAPACITOR	68pF,50V
						C569			NDC21HJ-680X	CAPACITOR	68pF,50V
						C570			NDC21HJ-680X	CAPACITOR	68pF,50V
						C571			NDC21HJ-680X	CAPACITOR	68pF,50V
						C572			NDC21HJ-680X	CAPACITOR	68pF,50V
						C573			NDC21HJ-680X	CAPACITOR	68pF,50V
						L501			QQL29BJ-100Z	COIL	10μH
						L503			QQL29BJ-100Z	COIL	10μH
						L504			QQL29BJ-100Z	COIL	10μH

S-SUB BOARD ASSEMBLY <15>

PW1	LPA10103-02A	S-SUB BOARD ASSY	
IC501	JCP8018	IC	
	or JCP8028	IC	
	or JCP8028-01	IC	
	or JCP8038	IC	
IC502	VC2076DP	IC	
R503	NRSA02J-221X	MG RESISTOR	220Ω,1/10W
R504	NRSA02J-332X	MG RESISTOR	3.3kΩ,1/10W
R505	NRSA02J-392X	MG RESISTOR	3.9kΩ,1/10W
R506	NRSA02J-391X	MG RESISTOR	390Ω,1/10W
R507	NRSA02J-122X	MG RESISTOR	1.2kΩ,1/10W
R508	NRSA02J-151X	MG RESISTOR	150Ω,1/10W
R509	NRSA02J-162X	MG RESISTOR	1.6kΩ,1/10W
R510	NRVA02D-102X	CMF RESISTOR	1kΩ,1/10W
R511	NRVA02D-471X	CMF RESISTOR	470Ω,1/10W
R512	NRVA02D-102X	CMF RESISTOR	1kΩ,1/10W
R513	NRVA02D-152X	CMF RESISTOR	1.5kΩ,1/10W
R514	NRVA02D-332X	CMF RESISTOR	3.3kΩ,1/10W
R515	NRVA02D-332X	CMF RESISTOR	3.3kΩ,1/10W
R516	NRSA02J-0R0X	MG RESISTOR	0Ω,1/10W
R517	NRSA02J-0R0X	MG RESISTOR	0Ω,1/10W
R525	NRSA02J-125X	MG RESISTOR	1.2MΩ,1/10W

#	REF No.	PART No.	PART NAME, DESCRIPTION
BK1		LP40077-001A	BRACKET(BOARD)
CN511		QGG2503K2-30	HEADER PIN,(1-30)MAIN
CN512		QGF1209F2-14	FFC/FPC CONNE,(1-14)TERMINAL
CN513		QGF1208F1-09	FPC CONNECTOR,(1-9)P/S

**NAVIGATION BOARD ASSEMBLY <19>
[LPB10108-001*] (HR-S8700MS/S9700MS)**

There are currently two types of Navigation boards in used, these are the LPB10108-001* and the LPB10108-002*.

These two boards have different Schematic Diagrams and Parts Lists. Be sure to check the board number before selecting its corresponding Schematic Diagram and Parts List.

PW1	LPA10108-01B	NAVIGATION BOARD ASSY	
IC3301	MN101C12GCG	IC	
	or MN101C49HCG	IC	
	or MN101CP12GAFCG	IC	
	or MN101CP49KAFCG	IC	
IC3401	74HC4053D	IC	
IC3402	74HC4053D	IC	
IC3403	AT45D011-SC-X	IC	
IC3405	TC7W241FU	IC(DIGITAL)	
IC3406	TC7W241FU	IC(DIGITAL)	
D3401	RB751V-40-X	SB DIODE	
D3402	RB751V-40-X	SB DIODE	
D3407	1SS355	DIODE	
R3302	NRSA02J-0R0X	MG RESISTOR	0Ω,1/10W
R3313	NRSA02J-0R0X	MG RESISTOR	0Ω,1/10W
R3321	NRSA02J-0R0X	MG RESISTOR	0Ω,1/10W
R3322	NRSA02J-0R0X	MG RESISTOR	0Ω,1/10W
R3323	NRSA02J-0R0X	MG RESISTOR	0Ω,1/10W
R3326	NRSA02J-102X	MG RESISTOR	1kΩ,1/10W
R3328	NRSA02J-0R0X	MG RESISTOR	0Ω,1/10W
R3329	NRSA02J-0R0X	MG RESISTOR	0Ω,1/10W
R3330	NRSA02J-0R0X	MG RESISTOR	0Ω,1/10W
R3331	NRSA02J-223X	MG RESISTOR	22kΩ,1/10W
R3332	NRSA02J-223X	MG RESISTOR	22kΩ,1/10W
R3333	NRSA02J-102X	MG RESISTOR	1kΩ,1/10W
R3339	NRSA02J-102X	MG RESISTOR	1kΩ,1/10W
R3340	NRSA02J-102X	MG RESISTOR	1kΩ,1/10W
R3342	NRSA02J-0R0X	MG RESISTOR	0Ω,1/10W
R3343	NRSA02J-0R0X	MG RESISTOR	0Ω,1/10W
R3345	NRSA02J-0R0X	MG RESISTOR	0Ω,1/10W
R3346	NRSA02J-0R0X	MG RESISTOR	0Ω,1/10W
R3347	NRSA02J-0R0X	MG RESISTOR	0Ω,1/10W
R3348	NRSA02J-0R0X	MG RESISTOR	0Ω,1/10W
R3349	NRSA02J-0R0X	MG RESISTOR	0Ω,1/10W
R3350	NRSA02J-0R0X	MG RESISTOR	0Ω,1/10W
R3351	NRSA02J-0R0X	MG RESISTOR	0Ω,1/10W
R3352	NRSA02J-0R0X	MG RESISTOR	0Ω,1/10W
R3371	NRSA02J-0R0X	MG RESISTOR	0Ω,1/10W
R3372	NRSA02J-0R0X	MG RESISTOR	0Ω,1/10W
R3373	NRSA02J-0R0X	MG RESISTOR	0Ω,1/10W
R3386	NRSA02J-103X	MG RESISTOR	10kΩ,1/10W
R3401	NRSA02J-0R0X	MG RESISTOR	0Ω,1/10W
R3402	NRSA02J-0R0X	MG RESISTOR	0Ω,1/10W
R3403	NRSA02J-0R0X	MG RESISTOR	0Ω,1/10W

#	REF No.	PART No.	PART NAME, DESCRIPTION
R3404		NRSA02J-0R0X	MG RESISTOR 0Ω,1/10W
R3412		NRSA02J-0R0X	MG RESISTOR 0Ω,1/10W
R3414		NRSA02J-0R0X	MG RESISTOR 0Ω,1/10W
R3415		NRSA02J-0R0X	MG RESISTOR 0Ω,1/10W
R3422		NRSA02J-0R0X	MG RESISTOR 0Ω,1/10W
R3432		NRSA02J-0R0X	MG RESISTOR 0Ω,1/10W
R3452		NRSA02J-223X	MG RESISTOR 22kΩ,1/10W
R3462		NRSA02J-103X	MG RESISTOR 10kΩ,1/10W
R3463		NRSA02J-223X	MG RESISTOR 22kΩ,1/10W
R3464		NRSA02J-223X	MG RESISTOR 22kΩ,1/10W
R3465		NRSA02J-472X	MG RESISTOR 4.7kΩ,1/10W
R3466		NRSA02J-0R0X	MG RESISTOR 0Ω,1/10W
R3468		NRSA02J-103X	MG RESISTOR 10kΩ,1/10W
R3472		NRSA02J-472X	MG RESISTOR 4.7kΩ,1/10W
R3475		NRSA02J-103X	MG RESISTOR 10kΩ,1/10W
C3312		NDC21HJ-120X	CAPACITOR 12pF,50V
C3313		NDC21HJ-120X	CAPACITOR 12pF,50V
C3314		NCB21EK-104X	CAPACITOR 0.1μF,25V
C3321		NDC21HJ-220X	CAPACITOR 22pF,50V
C3322		NDC21HJ-220X	CAPACITOR 22pF,50V
C3323		NDC21HJ-220X	CAPACITOR 22pF,50V
C3333		NCB21EK-104X	CAPACITOR 0.1μF,25V
C3345		NDC21HJ-220X	CAPACITOR 22pF,50V
C3346		NDC21HJ-220X	CAPACITOR 22pF,50V
C3347		NDC21HJ-220X	CAPACITOR 22pF,50V
C3401		QEKJ0JM-226	E CAPACITOR 22μF,6.3V
C3402		NCB21EK-104X	CAPACITOR 0.1μF,25V
C3403		NCB21EK-104X	CAPACITOR 0.1μF,25V
C3404		NCB21EK-104X	CAPACITOR 0.1μF,25V
C3405		NCB21EK-104X	CAPACITOR 0.1μF,25V
C3414		NCB21EK-104X	CAPACITOR 0.1μF,25V
X3301		QAX0584-001	CRYSTAL RESONATOR
BK1		LP40425-001A	BRACKET(BOARD)
CN3401		QGG2502K1-13	HEADER PIN,(1-13)MAIN
CN3402		QGF1207F1-08	FPC CONNECTOR,(1-8)TERMINAL

**NAVIGATION BOARD ASSEMBLY <19>
[LPB10108-002*] (HR-S9700MS)**

PW1	LPA10108-11A	NAVIGATION BOARD ASSY	
IC3301	MN101C12GCG	IC	
	or MN101C49HCG	IC	
	or MN101CP12GAFCG	IC	
	or MN101CP49KAFCG	IC	
IC3401	74HC4053D	IC	
IC3402	74HC4053D	IC	
IC3403	AT45DB011-SC-X	IC	
IC3405	TC7W241FU	IC(DIGITAL)	
IC3406	TC7W241FU	IC(DIGITAL)	
IC3408	SN74LV08APW	IC	
IC3409	TC7WT125FU	IC(DIGITAL)	
Q3403	2SD1450/ST-T	TRANSISTOR	
D3401	RB751V-40-X	SB DIODE	
D3402	RB751V-40-X	SB DIODE	
D3407	1SS355	DIODE	
D3408	RD3.6ES/B2/-T2	ZENER DIODE	
	or MTZJ3.6B	ZENER DIODE	

#	△ REF No.	PART No.	PART NAME, DESCRIPTION	
R3302		NRSA02J-0R0X	MG RESISTOR	0Ω,1/10W
R3313		NRSA02J-0R0X	MG RESISTOR	0Ω,1/10W
R3321		NRSA02J-0R0X	MG RESISTOR	0Ω,1/10W
R3322		NRSA02J-0R0X	MG RESISTOR	0Ω,1/10W
R3323		NRSA02J-0R0X	MG RESISTOR	0Ω,1/10W
R3326		NRSA02J-102X	MG RESISTOR	1kΩ,1/10W
R3328		NRSA02J-0R0X	MG RESISTOR	0Ω,1/10W
R3329		NRSA02J-0R0X	MG RESISTOR	0Ω,1/10W
R3330		NRSA02J-0R0X	MG RESISTOR	0Ω,1/10W
R3331		NRSA02J-223X	MG RESISTOR	22kΩ,1/10W
R3332		NRSA02J-223X	MG RESISTOR	22kΩ,1/10W
R3333		NRSA02J-331X	MG RESISTOR	330Ω,1/10W
R3339		NRSA02J-102X	MG RESISTOR	1kΩ,1/10W
R3340		NRSA02J-102X	MG RESISTOR	1kΩ,1/10W
R3342		NRSA02J-0R0X	MG RESISTOR	0Ω,1/10W
R3343		NRSA02J-0R0X	MG RESISTOR	0Ω,1/10W
R3345		NRSA02J-0R0X	MG RESISTOR	0Ω,1/10W
R3346		NRSA02J-0R0X	MG RESISTOR	0Ω,1/10W
R3347		NRSA02J-0R0X	MG RESISTOR	0Ω,1/10W
R3348		NRSA02J-0R0X	MG RESISTOR	0Ω,1/10W
R3349		NRSA02J-0R0X	MG RESISTOR	0Ω,1/10W
R3350		NRSA02J-0R0X	MG RESISTOR	0Ω,1/10W
R3351		NRSA02J-0R0X	MG RESISTOR	0Ω,1/10W
R3352		NRSA02J-0R0X	MG RESISTOR	0Ω,1/10W
R3371		NRSA02J-0R0X	MG RESISTOR	0Ω,1/10W
R3372		NRSA02J-0R0X	MG RESISTOR	0Ω,1/10W
R3373		NRSA02J-0R0X	MG RESISTOR	0Ω,1/10W
R3386		NRSA02J-103X	MG RESISTOR	10kΩ,1/10W
R3401		NRSA02J-0R0X	MG RESISTOR	0Ω,1/10W
R3402		NRSA02J-0R0X	MG RESISTOR	0Ω,1/10W
R3403		NRSA02J-0R0X	MG RESISTOR	0Ω,1/10W
R3404		NRSA02J-0R0X	MG RESISTOR	0Ω,1/10W
R3412		NRSA02J-0R0X	MG RESISTOR	0Ω,1/10W
R3414		NRSA02J-0R0X	MG RESISTOR	0Ω,1/10W
R3415		NRSA02J-0R0X	MG RESISTOR	0Ω,1/10W
R3422		NRSA02J-0R0X	MG RESISTOR	0Ω,1/10W
R3432		NRSA02J-0R0X	MG RESISTOR	0Ω,1/10W
R3462		NRSA02J-103X	MG RESISTOR	10kΩ,1/10W
R3465		NRSA02J-472X	MG RESISTOR	4.7kΩ,1/10W
R3466		NRSA02J-0R0X	MG RESISTOR	0Ω,1/10W
R3468		NRSA02J-103X	MG RESISTOR	10kΩ,1/10W
R3472		NRSA02J-472X	MG RESISTOR	4.7kΩ,1/10W
R3475		NRSA02J-103X	MG RESISTOR	10kΩ,1/10W
R3476		NRSA02J-101X	MG RESISTOR	100Ω,1/10W
R3477		NRSA02J-271X	MG RESISTOR	270Ω,1/10W
C3312		NDC21HJ-120X	CAPACITOR	12pF,50V
C3313		NDC21HJ-120X	CAPACITOR	12pF,50V
C3314		NCB21EK-104X	CAPACITOR	0.1μF,25V
C3321		NDC21HJ-220X	CAPACITOR	22pF,50V
C3322		NDC21HJ-220X	CAPACITOR	22pF,50V
C3323		NDC21HJ-220X	CAPACITOR	22pF,50V
C3333		NRSA02J-472X	MG RESISTOR	4.7kΩ,1/10W
C3345		NDC21HJ-220X	CAPACITOR	22pF,50V
C3346		NDC21HJ-220X	CAPACITOR	22pF,50V
C3347		NDC21HJ-220X	CAPACITOR	22pF,50V
C3401		QEKJ0JM-226	E CAPACITOR	22μF,6.3V
C3402		NCB21EK-104X	CAPACITOR	0.1μF,25V
C3403		NCB21EK-104X	CAPACITOR	0.1μF,25V
C3404		NCB21EK-104X	CAPACITOR	0.1μF,25V
C3405		NCB21EK-104X	CAPACITOR	0.1μF,25V
C3414		NCB21EK-104X	CAPACITOR	0.1μF,25V

#	△ REF No.	PART No.	PART NAME, DESCRIPTION	
C3416		NCB21EK-104X	CAPACITOR	0.1μF,25V
C3417		NCB21EK-104X	CAPACITOR	0.1μF,25V
C3419		NCB21HK-103X	CAPACITOR	0.01μF,50V
X3301		QAX0584-001	CRYSTAL RESONATOR	
BK1		LP40425-001A	BRACKET(BOARD)	
CN3401		QGG2502K1-13	HEADER PIN,(1-13)MAIN	
CN3402		QGF1207F1-08	FPC CONNECTOR,(1-8)TERMINAL	

DISPLAY BOARD ASSEMBLY(S8700MS) <28>				
PW1		LPA10056-10A1	DISPLAY BOARD ASSY	
IC7001		M35500BGP	IC	
		or M35500BFP	IC	
		or M35500AGP	IC	
IC7002		PNA4652M00XB	IR DETECT UNIT	
		or GP1U281X	IR DETECT UNIT	
D7002		RD9.1ES/B2/-T2	ZENER DIODE	
		or UZ9.1BSB	ZENER DIODE	
		or MTZJ9.1B	ZENER DIODE	
D7004		1SS133	DIODE	
D7005		1SS133	DIODE	
D7006		1SS133	DIODE	
D7009		SLR-342MC3F	LE DIODE	
D7010		SLR-342VC3F	LE DIODE	
D7011		SLR-342MC3F	LE DIODE	
R7001		QRE141J-471Y	RESISTOR	470Ω,1/4W
R7002		QRE141J-471Y	RESISTOR	470Ω,1/4W
R7003		QRE141J-471Y	RESISTOR	470Ω,1/4W
R7004		QRE141J-471Y	RESISTOR	470Ω,1/4W
R7005		QRE141J-103Y	RESISTOR	10kΩ,1/4W
R7006		QRE141J-103Y	RESISTOR	10kΩ,1/4W
R7007		QRE141J-103Y	RESISTOR	10kΩ,1/4W
R7008		QRE141J-103Y	RESISTOR	10kΩ,1/4W
R7013		QRE141J-103Y	RESISTOR	10kΩ,1/4W
R7020		QRE141J-103Y	RESISTOR	10kΩ,1/4W
R7021		QRE141J-122Y	RESISTOR	1.2kΩ,1/4W
R7022		QRE141J-182Y	RESISTOR	1.8kΩ,1/4W
R7023		QRE141J-222Y	RESISTOR	2.2kΩ,1/4W
R7024		QRE141J-272Y	RESISTOR	2.7kΩ,1/4W
R7025		QRE141J-472Y	RESISTOR	4.7kΩ,1/4W
R7026		QRE141J-682Y	RESISTOR	6.8kΩ,1/4W
R7027		QRE141J-153Y	RESISTOR	15kΩ,1/4W
R7028		QRE141J-393Y	RESISTOR	39kΩ,1/4W
R7030		QRE141J-103Y	RESISTOR	10kΩ,1/4W
R7031		QRE141J-122Y	RESISTOR	1.2kΩ,1/4W
R7032		QRE141J-182Y	RESISTOR	1.8kΩ,1/4W
R7033		QRE141J-222Y	RESISTOR	2.2kΩ,1/4W
R7034		QRE141J-153Y	RESISTOR	15kΩ,1/4W
R7037		QRE141J-153Y	RESISTOR	15kΩ,1/4W
R7038		QRE141J-393Y	RESISTOR	39kΩ,1/4W
R7040		QRE141J-331Y	RESISTOR	330Ω,1/4W
R7041		QRE141J-331Y	RESISTOR	330Ω,1/4W
R7042		QRE141J-331Y	RESISTOR	330Ω,1/4W
C7001		QCFB1HZ-104	CAPACITOR	0.1μF,50V
C7002		QETN1HM-106	E CAPACITOR	10μF,50V
C7007		QETN1HM-476	E CAPACITOR	47μF,50V
C7009		QCSB1HJ-150	CAPACITOR	15pF,50V

#	△ REF No.	PART No.	PART NAME, DESCRIPTION
C7010		QCFB1HZ-104	CAPACITOR 0.1μF,50V
C7011		QETN1AM-227	E CAPACITOR 220μF,10V
C7019		QDVB1EZ-223Y	CAPACITOR 0.022μF,25V
S7001		QSW0456-002Z	TACT SWITCH,STAND BY
S7002		QSW0456-002Z	TACT SWITCH,CH+
S7003		QSW0456-002Z	TACT SWITCH,CH-
S7004		QSW0456-002Z	TACT SWITCH,REC
S7005		QSW0456-002Z	TACT SWITCH,PAUSE
S7006		QSW0456-002Z	TACT SWITCH,PLAY
S7007		QSW0456-002Z	TACT SWITCH,STOP/EJECT
S7010		QSW0456-002Z	TACT SWITCH,D.TBC/NR
S7011		QSW0456-002Z	TACT SWITCH,TIMER
S7012		QSW0456-002Z	TACT SWITCH,SVHS ET
S7013		QSW0456-002Z	TACT SWITCH,SAT.CTL
S7014		QSW0456-002Z	TACT SWITCH,SP/LP
S7015		QSW0456-002Z	TACT SWITCH,SYN.EDIT
S7016		QSW0456-002Z	TACT SWITCH,INSERT
S7017		QSW0456-002Z	TACT SWITCH,A.DUB
DI7001		QLF0032-002	FL TUBE
HD1		LP30428-001A	FDP HOLDER(L),DI7001
HD2		LP30429-001A	FDP HOLDER(R),DI7001
HD3		PQM30038-2-2	LED HOLDER,D7009
HD4		PQM30038-1-2	LED HOLDER,D7010
HD5		PQM30038-2-2	LED HOLDER,D7011
CN7001		QGF1207C1-14	FPC CONNECTOR,(1-14)MAIN

#	△ REF No.	PART No.	PART NAME, DESCRIPTION
R7013		QRE141J-103Y	RESISTOR 10kΩ,1/4W
R7020		QRE141J-103Y	RESISTOR 10kΩ,1/4W
R7021		QRE141J-122Y	RESISTOR 1.2kΩ,1/4W
R7022		QRE141J-182Y	RESISTOR 1.8kΩ,1/4W
R7023		QRE141J-222Y	RESISTOR 2.2kΩ,1/4W
R7024		QRE141J-272Y	RESISTOR 2.7kΩ,1/4W
R7025		QRE141J-472Y	RESISTOR 4.7kΩ,1/4W
R7026		QRE141J-682Y	RESISTOR 6.8kΩ,1/4W
R7027		QRE141J-153Y	RESISTOR 15kΩ,1/4W
R7028		QRE141J-393Y	RESISTOR 39kΩ,1/4W
R7030		QRE141J-103Y	RESISTOR 10kΩ,1/4W
R7031		QRE141J-122Y	RESISTOR 1.2kΩ,1/4W
R7032		QRE141J-182Y	RESISTOR 1.8kΩ,1/4W
R7033		QRE141J-222Y	RESISTOR 2.2kΩ,1/4W
R7034		QRE141J-272Y	RESISTOR 2.7kΩ,1/4W
R7035		QRE141J-472Y	RESISTOR 4.7kΩ,1/4W
R7036		QRE141J-682Y	RESISTOR 6.8kΩ,1/4W
R7037		QRE141J-153Y	RESISTOR 15kΩ,1/4W
R7038		QRE141J-393Y	RESISTOR 39kΩ,1/4W
R7040		QRE141J-331Y	RESISTOR 330Ω,1/4W
R7041		QRE141J-331Y	RESISTOR 330Ω,1/4W
R7042		QRE141J-331Y	RESISTOR 330Ω,1/4W
R7044		QRE141J-104Y	RESISTOR 100kΩ,1/4W
R7045		QRE141J-102Y	RESISTOR 1kΩ,1/4W
R7046		QRE141J-394Y	RESISTOR 390kΩ,1/4W
R7047		QRE141J-101Y	RESISTOR 100Ω,1/4W
R7048		QRE141J-472Y	RESISTOR 4.7kΩ,1/4W
C7001		QCFB1HZ-104	CAPACITOR 0.1μF,50V
C7002		QETN1HM-106	E CAPACITOR 10μF,50V
C7007		QETN1HM-476	E CAPACITOR 47μF,50V
C7009		QCSB1HJ-150	CAPACITOR 15pF,50V
C7010		QCFB1HZ-104	CAPACITOR 0.1μF,50V
C7011		QETN1AM-227	E CAPACITOR 220μF,10V
C7019		QDVB1EZ-223Y	CAPACITOR 0.022μF,25V
C7022		QDVB1EZ-223Y	CAPACITOR 0.022μF,25V
C7192		QCBB1HJ-681	CAPACITOR 680pF,50V
C7194		QCBB1HJ-681	CAPACITOR 680pF,50V
C7197		QCBB1HK-221	CAPACITOR 220pF,50V
L7191		QRE141J-101Y	RESISTOR 100Ω,1/4W
L7192		QRE141J-101Y	RESISTOR 100Ω,1/4W
L7196		QLL071J-1R0Y	COIL 1μH
S7001		QSW0456-002Z	TACT SWITCH,STAND-BY
S7002		QSW0456-002Z	TACT SWITCH,A.MONITOR
S7003		QSW0456-002Z	TACT SWITCH,C.RESET
S7004		QSW0456-002Z	TACT SWITCH,IN/OUT
S7005		QSW0456-002Z	TACT SWITCH,RAE
S7006		QSW0456-002Z	TACT SWITCH,START
S7007		QSW0456-002Z	TACT SWITCH,STOP/EJECT
S7008		QSW0456-002Z	TACT SWITCH,MARK
S7009		QSW0456-002Z	TACT SWITCH,ERASE
S7010		QSW0456-002Z	TACT SWITCH,D.TBC/NR
S7011		QSW0456-002Z	TACT SWITCH,SP/LP/EP
S7012		QSW0456-002Z	TACT SWITCH,TIMER
S7013		QSW0456-002Z	TACT SWITCH,SAT.CTL
S7014		QSW0456-002Z	TACT SWITCH,VCR/TV
S7015		QSW0456-002Z	TACT SWITCH,SYN.EDIT
S7016		QSW0456-002Z	TACT SWITCH,SVHS ET
S7017		QSW0456-002Z	TACT SWITCH,DISPLAY
DI7001		QLF0032-002	FL TUBE
HD1		LP30428-001A	FDP HOLDER(L),DI7001
HD2		LP30429-001A	FDP HOLDER(R),DI7001

DISPLAY BOARD ASSEMBLY(S9700MS) <28>

PW1	LPA10067-02A1	DISPLAY BOARD ASSY
IC7001	M35500BGP	IC
	or M35500BFP	IC
	or M35500AGP	IC
IC7002	PNA4652M00XB	IR DETECT UNIT
	or GP1U281X	IR DETECT UNIT
Q7001	DTC144WS	TRANSISTOR
Q7002	2SC1740S/QRS/-T	TRANSISTOR
	or 2SC3199/YG/-T	TRANSISTOR
Q7003	2SA933AS/QRS/-T	TRANSISTOR
	or 2SA1267/YG/-T	TRANSISTOR
D7002	RD9.1ES/B2/-T2	ZENER DIODE
	or UZ9.1BSB	ZENER DIODE
	or MTZJ9.1B	ZENER DIODE
D7004	1SS133	DIODE
D7005	1SS133	DIODE
D7006	1SS133	DIODE
D7007	1SS133	DIODE
D7012	1SS133	DIODE
D7013	1SS133	DIODE
D7014	1SS133	DIODE
R7001	QRE141J-471Y	RESISTOR 470Ω,1/4W
R7002	QRE141J-471Y	RESISTOR 470Ω,1/4W
R7003	QRE141J-471Y	RESISTOR 470Ω,1/4W
R7004	QRE141J-471Y	RESISTOR 470Ω,1/4W
R7005	QRE141J-103Y	RESISTOR 10kΩ,1/4W
R7006	QRE141J-103Y	RESISTOR 10kΩ,1/4W
R7007	QRE141J-103Y	RESISTOR 10kΩ,1/4W
R7008	QRE141J-103Y	RESISTOR 10kΩ,1/4W

#	△ REF No.	PART No.	PART NAME, DESCRIPTION
		OT1	PU59915-105 #500SPACER0.01,C7197
		J7191	PEMC1126-04 PIN JACK,VIDEO IN
		J7192	PEMC0922-03 PIN JACK(SW),A(L)IN
		J7193	PEMC0922-02 PIN JACK(SW),A(R)IN
		J7194	QND0085-001 S JACK,S VIDEO
		CN7001	QGF1207C1-14 FPC CONNECTOR,(1-14)MAIN
		CN7002	QGF1202C1-08 FPC CONNECTOR,(1-8)M.DOOR
		CN7191	QGF1207C1-05 FPC CONNECTOR,(3-7)MAIN
		CN7192	QGF1207C1-04 FPC CONNECTOR,(1-4)

REC SAFETY BOARD ASSEMBLY(S9700MS)<32>

PW2	LPA10067-01B2	REC SAFETY BOARD ASSY
S7041	QSW0602-004	PUSH SWITCH
FW7001	QUM032-07A4A4	PARA RIBON WIRE

REC SAFETY BOARD ASSEMBLY(S8700MS) <32>

PW2	LPA10056-01A2	REC SAFETY BOARD ASSY
S7041	QSW0602-004	PUSH SWITCH
FW7001	QUM032-07A4A4	PARA RIBON WIRE

S JACK BOARD ASSEMBLY (S8700MS) <36>

PW4	LPA10056-10A4	S JACK BOARD ASSY
C7192	QCBB1HJ-681	CAPACITOR 680pF,50V
C7194	QCBB1HJ-681	CAPACITOR 680pF,50V
L7191	QRE141J-101Y	RESISTOR 100Ω,1/4W
L7192	QRE141J-101Y	RESISTOR 100Ω,1/4W
J7191	PEMC1009-04	PIN JACK,VIDEO IN
J7192	PEMC1010-03	PIN JACK(SW),AUDIO IN(L)
J7193	PEMC1010-02	PIN JACK(SW),AUDIO IN(R)
J7194	QND0084-001	S JACK,S VIDEO
CN7191	QGF1207F1-05	FPC CONNECTOR,(3-7)
CN7192	QGF1207F1-04	FPC CONNECTOR,(1-4)MAIN

JOG BOARD ASSEMBLY (S8700MS) <37>

PW3	LPA10056-10A3	JOG BOARD ASSY
UN7091	PEME0786-02	JOG SHUTTLE ASSY
CN7005	QGF1207F1-06	FPC CONNECTOR,(1-6)MAIN

△ REF No. PART No. PART NAME, DESCRIPTION

AUDIO ERASE BOARD ASSEMBLY <46>

PW2	LPA10106-03A2	AUDIO ERASE BOARD ASSY
Q2051	2SC4081/QRS/-X	TRANSISTOR
	or 2PC4081/R/-X	TRANSISTOR
	or 2SD1819A/QRS/-X	TRANSISTOR
R2054	NRSA02J-153X	MG RESISTOR 15kΩ,1/10W
R2055	NRSA02J-3R3X	MG RESISTOR 3.3Ω,1/10W
C2052	QFLC1HJ-333Z	F CAPACITOR 0.033μF,50V
C2053	NCB21HK-332X	CAPACITOR 0.0033μF,50V
C2054	NCB21HK-103X	CAPACITOR 0.01μF,50V
C2055	QEKJ1CM-106	E CAPACITOR 10μF,16V
T2051	PELN0860	OSC TRANSFORMER
CN2052	QGB2024J1-04S	CONNECTOR,(1-4)MAIN

LOADING MOTOR BOARD ASSEMBLY <55>

PW2	LPA10010-01A2	LOADING MOTOR BOARD ASSY
CN1	QGB2533K1-02	CONNECTOR

P/S CONVERTER BOARD ASSEMBLY <87>

PW1	PB11062E	P/S CONVERTER BOARD ASSY,S8700MS
	PB11062F	P/S CONVERTER BOARD ASSY,S9700MS
IC3502	TDA4650	IC
IC3503	TDA4665T	IC
IC3504	TDA2595	IC
IC3505	TDA8505	IC,S9700MS
IC3506	TDA8501T/N1-X	IC
IC3508	MM1233XF	IC,S9700MS
IC3509	MM1111XF	IC,S9700MS
IC3510	TC74HC4066AF	IC,S9700MS
IC3512	74HC74D	IC
IC3513	74HC4538D	IC
IC3514	74HC221D	IC
IC3515	MM1111XF	IC,S9700MS
IC3517	BA7046F	IC
	or BA7046F-XE	IC
IC3518	TA75S393F	IC,S9700MS
Q3504	2SD1819A/QRS/-X	TRANSISTOR
	or 2SC4081/QRS/-X	TRANSISTOR
	or 2PC4081/R/-X	TRANSISTOR
Q3505	2SB1218A/QR/-X	TRANSISTOR
	or 2SA1576A/QR/-X	TRANSISTOR
	or 2PA1576/R/-X	TRANSISTOR
Q3506	2SD1819A/QRS/-X	TRANSISTOR
	or 2SC4081/QRS/-X	TRANSISTOR
	or 2PC4081/R/-X	TRANSISTOR
Q3507	2SD1819A/QRS/-X	TRANSISTOR
	or 2SC4081/QRS/-X	TRANSISTOR
	or 2PC4081/R/-X	TRANSISTOR

#	△ REF No.	PART No.	PART NAME, DESCRIPTION	#	△ REF No.	PART No.	PART NAME, DESCRIPTION
Q3508		2SD1819A/QRS/-X	TRANSISTOR	D3504		1SS355	DIODE
		or 2SC4081/QRS/-X	TRANSISTOR	R3528		NRSA02J-511X	MG RESISTOR 510Ω,1/10W
		or 2PC4081/R/-X	TRANSISTOR	R3529		NRSA02J-681X	MG RESISTOR 680Ω,1/10W
Q3509		2SB1218A/QR/-X	TRANSISTOR	R3531		NRSA02J-563X	MG RESISTOR 56kΩ,1/10W
		or 2PA1576/R/-X	TRANSISTOR	R3532		NRSA02J-473X	MG RESISTOR 47kΩ,1/10W
		or 2SA1576A/QR/-X	TRANSISTOR	R3533		NRSA02J-122X	MG RESISTOR 1.2kΩ,1/10W
Q3510		2SD1819A/QRS/-X	TRANSISTOR	R3534		NRSA02J-681X	MG RESISTOR 680Ω,1/10W
		or 2SC4081/QRS/-X	TRANSISTOR	R3535		NRSA02J-681X	MG RESISTOR 680Ω,1/10W
		or 2PC4081/R/-X	TRANSISTOR	R3536		NRSA02J-331X	MG RESISTOR 330Ω,1/10W
Q3511		2SD1819A/QRS/-X	TRANSISTOR	R3537		NRSA02J-182X	MG RESISTOR 1.8kΩ,1/10W
		or 2PC4081/R/-X	TRANSISTOR	R3538		NRSA02J-102X	MG RESISTOR 1kΩ,1/10W
		or 2SC4081/QRS/-X	TRANSISTOR	R3539		NRSA02J-222X	MG RESISTOR 2.2kΩ,1/10W
Q3512		2SD1819A/QRS/-X	TRANSISTOR	R3540		NRSA02J-152X	MG RESISTOR 1.5kΩ,1/10W
		or 2SC4081/QRS/-X	TRANSISTOR	R3541		NRSA02J-153X	MG RESISTOR 15kΩ,1/10W
		or 2PC4081/R/-X	TRANSISTOR	R3542		NRSA02J-183X	MG RESISTOR 18kΩ,1/10W
Q3513		2SB1218A/QR/-X	TRANSISTOR	R3543		NRSA02J-122X	MG RESISTOR 1.2kΩ,1/10W
		or 2SA1576A/QR/-X	TRANSISTOR	R3544		NRSA02J-681X	MG RESISTOR 680Ω,1/10W
		or 2PA1576/R/-X	TRANSISTOR	R3545		NRSA02J-751X	MG RESISTOR 750Ω,1/10W
Q3514		2SD1819A/QRS/-X	TRANSISTOR	R3546		NRSA02J-121X	MG RESISTOR 120Ω,1/10W
		or 2SC4081/QRS/-X	TRANSISTOR	R3547		NRSA02J-122X	MG RESISTOR 1.2kΩ,1/10W
		or 2PC4081/R/-X	TRANSISTOR	R3548		NRSA02J-102X	MG RESISTOR 1kΩ,1/10W
Q3515		2SD1819A/QRS/-X	TRANSISTOR	R3549		NRSA02J-102X	MG RESISTOR 1kΩ,1/10W
		or 2SC4081/QRS/-X	TRANSISTOR	R3550		NRSA02J-102X	MG RESISTOR 1kΩ,1/10W
		or 2PC4081/R/-X	TRANSISTOR	R3551		NRSA02J-563X	MG RESISTOR 56kΩ,1/10W
Q3520		2SD1819A/QRS/-X	TRANSISTOR	R3552		NRSA02J-223X	MG RESISTOR 22kΩ,1/10W
		or 2SC4081/QRS/-X	TRANSISTOR	R3553		NRSA02J-122X	MG RESISTOR 1.2kΩ,1/10W
		or 2PC4081/R/-X	TRANSISTOR	R3554		NRSA02J-681X	MG RESISTOR 680Ω,1/10W
Q3525		2SD1819A/QRS/-X	TRANSISTOR	R3555		NRSA02J-821X	MG RESISTOR 820Ω,1/10W
		or 2PC4081/R/-X	TRANSISTOR	R3556		NRSA02J-121X	MG RESISTOR 120Ω,1/10W
		or 2SC4081/QRS/-X	TRANSISTOR	R3557		NRSA02J-152X	MG RESISTOR 1.5kΩ,1/10W
Q3531		DTC144TU	TRANSISTOR,S9700MS	R3558		NRSA02J-102X	MG RESISTOR 1kΩ,1/10W
Q3532		DTC144TU	TRANSISTOR,S9700MS	R3559		NRSA02J-102X	MG RESISTOR 1kΩ,1/10W
Q3533		DTC144EU	TRANSISTOR,S9700MS	R3560		NRSA02J-102X	MG RESISTOR 1kΩ,1/10W
Q3536		UN521E	TRANSISTOR,S9700MS	R3571		NRSA02J-221X	MG RESISTOR 220Ω,1/10W
		or DTC144WU	TRANSISTOR,S9700MS	R3572		NRSA02J-102X	MG RESISTOR 1kΩ,1/10W
		or PDTC144WU	TRANSISTOR,S9700MS	R3573		NRSA02J-221X	MG RESISTOR 220Ω,1/10W
		or RN1309	TRANSISTOR,S9700MS	R3574		NRSA02J-561X	MG RESISTOR 560Ω,1/10W
Q3540		2SD1819A/QRS/-X	TRANSISTOR	R3591		NRSA02J-681X	MG RESISTOR 680Ω,1/10W
		or 2PC4081/R/-X	TRANSISTOR	R3592		NRSA02J-331X	MG RESISTOR 330Ω,1/10W
		or 2SC4081/QRS/-X	TRANSISTOR	R3593		NRSA02J-331X	MG RESISTOR 330Ω,1/10W
Q3541		2SD1819A/QRS/-X	TRANSISTOR	R3594		NRSA02J-332X	MG RESISTOR 3.3kΩ,1/10W
		or 2SC4081/QRS/-X	TRANSISTOR	R3595		NRSA02J-103X	MG RESISTOR 10kΩ,1/10W
		or 2PC4081/R/-X	TRANSISTOR	R3596		NRSA02J-103X	MG RESISTOR 10kΩ,1/10W
Q3542		2SB1218A/QR/-X	TRANSISTOR	R3597		NRSA02J-101X	MG RESISTOR 100Ω,1/10W
		or 2SA1576A/QRS/-X	TRANSISTOR,S8700MS	R3598		NRSA02J-101X	MG RESISTOR 100Ω,1/10W
		or 2PA1576/R/-X	TRANSISTOR	R3599		NRSA02J-122X	MG RESISTOR 1.2kΩ,1/10W
		or 2SA1576A/QR/-X	TRANSISTOR,S9700MS	R3600		NRSA02J-102X	MG RESISTOR 1kΩ,1/10W
Q3543		2SD1819A/QRS/-X	TRANSISTOR	R3601		NRSA02J-681X	MG RESISTOR 680Ω,1/10W
		or 2PC4081/R/-X	TRANSISTOR	R3602		NRSA02J-101X	MG RESISTOR 100Ω,1/10W
		or 2SC4081/QRS/-X	TRANSISTOR	R3604		NRSA02J-331X	MG RESISTOR 330Ω,1/10W
Q3544		2SD1819A/QRS/-X	TRANSISTOR	R3605		NRSA02J-105X	MG RESISTOR 1MΩ,1/10W
		or 2SC4081/QRS/-X	TRANSISTOR	R3607		NRSA02J-101X	MG RESISTOR 100Ω,1/10W
		or 2PC4081/R/-X	TRANSISTOR	R3608		NRSA02J-183X	MG RESISTOR 18kΩ,1/10W
Q3545		2SB1218A/QR/-X	TRANSISTOR	R3609		NRSA02J-223X	MG RESISTOR 22kΩ,1/10W
		or 2SA1576A/QRS/-X	TRANSISTOR,S8700MS	R3610		NRSA02J-391X	MG RESISTOR,S9700MS 390Ω,1/10W
		or 2PA1576/R/-X	TRANSISTOR			NRSA02J-222X	MG RESISTOR,S8700MS 2.2kΩ,1/10W
		or 2SA1576A/QR/-X	TRANSISTOR,S9700MS	R3619		NRSA02J-222X	MG RESISTOR,S9700MS 2.2kΩ,1/10W
Q3546		2SD1819A/QRS/-X	TRANSISTOR	R3620		NRSA02J-472X	MG RESISTOR 4.7kΩ,1/10W
		or 2PC4081/R/-X	TRANSISTOR	R3621		NRSA02J-123X	MG RESISTOR 12kΩ,1/10W
		or 2SC4081/QRS/-X	TRANSISTOR	R3622		NRSA02J-124X	MG RESISTOR 120kΩ,1/10W
D3502		DAN202U	DIODE	R3623		NRSA02J-104X	MG RESISTOR 100kΩ,1/10W

#	△	REF No.	PART No.	PART NAME, DESCRIPTION	#	△	REF No.	PART No.	PART NAME, DESCRIPTION
R3624			NRSA02J-562X	MG RESISTOR 5.6kΩ,1/10W	C3539		QEKJ1CM-476	E CAPACITOR 47μF,16V	
R3627			NRSA02J-562X	MG RESISTOR 5.6kΩ,1/10W	C3540		NCB21CK-224X	CAPACITOR 0.22μF,16V	
R3628			NRSA02J-332X	MG RESISTOR 3.3kΩ,1/10W	C3541		NCB21HJ-103X	CAPACITOR 0.01μF,50V	
R3629			NRSA02J-0R0X	MG RESISTOR 0Ω,1/10W	C3542		NCB21HJ-103X	CAPACITOR 0.01μF,50V	
R3630			NRSA02J-103X	MG RESISTOR 10kΩ,1/10W	C3543		NDC21HJ-181X	CAPACITOR 180pF,50V	
R3631			NRSA02J-203X	MG RESISTOR 20kΩ,1/10W	C3544		NDC21HJ-181X	CAPACITOR 180pF,50V	
R3632			NRSA02J-333X	MG RESISTOR 33kΩ,1/10W	C3545		NCB21EK-104X	CAPACITOR 0.1μF,25V	
R3633			NRSA02J-391X	MG RESISTOR 390Ω,1/10W	C3546		NCB21EK-104X	CAPACITOR 0.1μF,25V	
R3634			NRSA02J-102X	MG RESISTOR,S9700MS 1kΩ,1/10W	C3547		NDC21HJ-270X	CAPACITOR 27pF,50V	
R3635			NRSA02J-101X	MG RESISTOR,S9700MS 100Ω,1/10W	C3548		NDC21HJ-270X	CAPACITOR 27pF,50V	
R3636			NRSA02J-223X	MG RESISTOR,S9700MS 22kΩ,1/10W	C3549		NCB21EK-104X	CAPACITOR 0.1μF,25V	
R3637			NRSA02J-182X	MG RESISTOR,S9700MS 1.8kΩ,1/10W	C3550		NCB21CK-474X	CAPACITOR 0.47μF,16V	
R3638			NRSA02J-122X	MG RESISTOR,S9700MS 1.2kΩ,1/10W	C3551		NDC21HJ-180X	CAPACITOR,S9700MS 18pF,50V	
R3652			NRSA02J-103X	MG RESISTOR,S9700MS 10kΩ,1/10W	C3552		NCB21EK-223X	CAPACITOR 0.022μF,25V	
R3653			NRSA02J-152X	MG RESISTOR,S9700MS 1.5kΩ,1/10W	C3553		NCB21EK-223X	CAPACITOR 0.022μF,25V	
R3654			NRSA02J-222X	MG RESISTOR 2.2kΩ,1/10W	C3554		NCB21HJ-103X	CAPACITOR 0.01μF,50V	
R3658			NRSA02J-103X	MG RESISTOR,S9700MS 10kΩ,1/10W	C3555		QEKJ1CM-107	E CAPACITOR 100μF,16V	
R3660			NRSA02J-154X	MG RESISTOR 150kΩ,1/10W	C3556		NCB21HJ-103X	CAPACITOR 0.01μF,50V	
R3666			NRSA02J-0R0X	MG RESISTOR,S9700MS 0Ω,1/10W	C3557		QEKJ1CM-476	E CAPACITOR 47μF,16V	
R3668			NRSA02J-391X	MG RESISTOR,S8700MS 390Ω,1/10W	C3558		NCB21HJ-103X	CAPACITOR 0.01μF,50V	
			NRSA02J-561X	MG RESISTOR,S9700MS 560Ω,1/10W	C3559		QEKJ1CM-476	E CAPACITOR 47μF,16V	
R3669			NRSA02J-122X	MG RESISTOR 1.2kΩ,1/10W	C3561		QEKJ1HM-335	E CAPACITOR 3.3μF,50V	
R3671			NRSA02J-122X	MG RESISTOR 1.2kΩ,1/10W	C3564		QEKJ1EM-475	E CAPACITOR 4.7μF,25V	
R3672			NRSA02J-102X	MG RESISTOR 1kΩ,1/10W	C3565		NCB21HJ-103X	CAPACITOR,S9700MS 0.01μF,50V	
R3673			NRSA02J-681X	MG RESISTOR 680Ω,1/10W	C3566		NCB21EK-223X	CAPACITOR 0.022μF,25V	
R3674			NRSA02J-101X	MG RESISTOR 100Ω,1/10W	C3567		NCB21CK-224X	CAPACITOR 0.22μF,16V	
R3676			NRSA02J-331X	MG RESISTOR 330Ω,1/10W	C3568		NCB21CK-224X	CAPACITOR 0.22μF,16V	
R3677			NRSA02J-331X	MG RESISTOR 330Ω,1/10W	C3569		NCB21HJ-103X	CAPACITOR 0.01μF,50V	
R3678			NRSA02J-474X	MG RESISTOR 470kΩ,1/10W	C3570		QFN31HJ-472	F CAPACITOR 0.0047μF,50V	
R3679			NRSA02J-103X	MG RESISTOR 10kΩ,1/10W	C3571		NCB21HK-472X	CAPACITOR 0.0047μF,50V	
R3681			NRSA02J-0R0X	MG RESISTOR 0Ω,1/10W	C3572		NCB21HJ-103X	CAPACITOR 0.01μF,50V	
R3682			NRSA02J-162X	MG RESISTOR 1.6kΩ,1/10W	C3573		QEKJ1EM-475	E CAPACITOR 4.7μF,25V	
R3683			NRSA02J-0R0X	MG RESISTOR 0Ω,1/10W	C3575		QEKJ1CM-476	E CAPACITOR 47μF,16V	
R3684			NRSA02J-103X	MG RESISTOR 10kΩ,1/10W	C3576		NCB21HJ-103X	CAPACITOR 0.01μF,50V	
R3685			NRSA02J-272X	MG RESISTOR 2.7kΩ,1/10W	C3577		NDC21HJ-561X	CAPACITOR 560pF,50V	
R3686			NRSA02J-333X	MG RESISTOR 33kΩ,1/10W	C3578		NCB21HJ-103X	CAPACITOR 0.01μF,50V	
R3687			NRSA02J-103X	MG RESISTOR 10kΩ,1/10W	C3581		QEKJ1HM-105	E CAPACITOR,S9700MS 1μF,50V	
R3688			NRSA02J-474X	MG RESISTOR 470kΩ,1/10W	C3582		QEKJ1HM-105	E CAPACITOR,S9700MS 1μF,50V	
R3689			NRSA02J-134X	MG RESISTOR 130kΩ,1/10W	C3583		NCB21HJ-102X	CAPACITOR,S9700MS 0.001μF,50V	
R3691			NRSA02J-123X	MG RESISTOR 12kΩ,1/10W	C3584		NCB21HJ-103X	CAPACITOR,S9700MS 0.01μF,50V	
R3692			NRSA02J-102X	MG RESISTOR 1kΩ,1/10W	C3585		NCB21HK-682X	CAPACITOR,S9700MS 0.0068μF,50V	
R3693			NRSA02J-183X	MG RESISTOR,S9700MS 18kΩ,1/10W	C3586		NCB21CK-224X	CAPACITOR,S9700MS 0.22μF,16V	
R3694			NRSA02J-103X	MG RESISTOR,S9700MS 10kΩ,1/10W	C3587		NCB21HJ-103X	CAPACITOR,S9700MS 0.01μF,50V	
R3695			NRSA02J-102X	MG RESISTOR,S9700MS 1kΩ,1/10W	C3588		NCB21HJ-103X	CAPACITOR,S9700MS 0.01μF,50V	
VR3501			QVP0039-223Z	TRIM RESISTOR,FH FREE RUN ADJ	C3589		QFN31HJ-104	F CAPACITOR,S9700MS 0.1μF,50V	
VR3502			QVP0039-471Z	TRIM RESISTOR,SECAM DECODER	C3590		NDC21HJ-120X	CAPACITOR,S9700MS 12pF,50V	
VR3503			QVP0039-104Z	TRIM RESISTOR,PAL BURST ADJ	C3591		NCB21EK-223X	CAPACITOR,S9700MS 0.022μF,25V	
VR3504			QVP0039-472Z	TRIM RESISTOR,SECAM BELL,S9700MS	C3592		NCB21HJ-103X	CAPACITOR,S9700MS 0.01μF,50V	
VR3505			QVP0039-471Z	TRIM RESISTOR,R-Y LEVEL	C3593		NCB21HJ-103X	CAPACITOR,S9700MS 0.01μF,50V	
VR3506			QVP0039-471Z	TRIM RESISTOR,B-Y LEVEL	C3594		QEKJ1CM-476	E CAPACITOR,S9700MS 47μF,16V	
C3526			NDC21HJ-121X	CAPACITOR 120pF,50V	C3595		QEKJ1HM-105	E CAPACITOR,S9700MS 1μF,50V	
C3527			NCB21HJ-103X	CAPACITOR 0.01μF,50V	C3596		QEKJ1HM-474	E CAPACITOR,S9700MS 0.47μF,50V	
C3528			NCB21HJ-103X	CAPACITOR 0.01μF,50V	C3597		QEKJ1CM-476	E CAPACITOR,S9700MS 47μF,16V	
C3529			NCB21HJ-103X	CAPACITOR 0.01μF,50V	C3598		QEKJ1EM-475	E CAPACITOR,S9700MS 4.7μF,25V	
C3530			NDC21HJ-101X	CAPACITOR 100pF,50V	C3599		QEKJ1CM-476	E CAPACITOR,S9700MS 47μF,16V	
C3531			NCB21HJ-103X	CAPACITOR 0.01μF,50V	C3600		QEKJ1HM-105	E CAPACITOR 1μF,50V	
C3532			NCB21HJ-103X	CAPACITOR 0.01μF,50V	C3601		QEKJ1HM-105	E CAPACITOR 1μF,50V	
C3533			NCB21HJ-103X	CAPACITOR 0.01μF,50V	C3602		NCB21CK-224X	CAPACITOR 0.22μF,16V	
C3535			QEKJ1CM-476	E CAPACITOR 47μF,16V	C3603		NCB21HJ-103X	CAPACITOR 0.01μF,50V	
C3536			QEKJ1CM-106	E CAPACITOR 10μF,16V	C3604		NCB21CK-224X	CAPACITOR 0.22μF,16V	
C3537			QEKJ1CM-106	E CAPACITOR 10μF,16V	C3605		NCB21EK-223X	CAPACITOR 0.022μF,25V	

#	△ REF No.	PART No.	PART NAME, DESCRIPTION
C3606		NCB21HJ-103X	CAPACITOR 0.01μF,50V
C3607		NCB21CK-224X	CAPACITOR 0.22μF,16V
C3608		NDC21HG-150X	CAPACITOR 15pF,50V
C3609		NCB21EK-223X	CAPACITOR 0.022μF,25V
C3610		QEKJ1CM-476	E CAPACITOR 47μF,16V
C3611		QEKJ1CM-476	E CAPACITOR 47μF,16V
C3612		NCB21HJ-103X	CAPACITOR 0.01μF,50V
C3613		NCB21HJ-103X	CAPACITOR 0.01μF,50V
C3614		NDC21HJ-222X	CAPACITOR 0.0022μF,50V
C3615		NCB21HJ-103X	CAPACITOR 0.01μF,50V
C3616		NDC21HJ-101X	CAPACITOR 100pF,50V
C3617		NCB21HJ-103X	CAPACITOR,S9700MS 0.01μF,50V
C3618		NDC21HJ-2R0X	CAPACITOR 2pF,50V
C3619		NCB21HJ-103X	CAPACITOR,S9700MS 0.01μF,50V
C3625		QEKJ1CM-476	E CAPACITOR 47μF,16V
C3628		QEQF1HM-105	NP E CAPACITOR,S9700MS 1μF,50V
C3629		QEQF1HM-105	NP E CAPACITOR,S9700MS 1μF,50V
C3630		NCB21HJ-103X	CAPACITOR,S9700MS 0.01μF,50V
C3632		NCB21HJ-103X	CAPACITOR,S9700MS 0.01μF,50V
C3633		NCB21HJ-103X	CAPACITOR,S9700MS 0.01μF,50V
C3634		QEKJ1CM-106	E CAPACITOR,S9700MS 10μF,16V
C3639		QEKJ1CM-106	E CAPACITOR,S9700MS 10μF,16V
C3640		QEKJ1CM-476	E CAPACITOR,S9700MS 47μF,16V
C3647		NCB21HJ-103X	CAPACITOR,S9700MS 0.01μF,50V
C3648		QEKJ1HM-105	E CAPACITOR 1μF,50V
C3649		NCB21HJ-103X	CAPACITOR 0.01μF,50V
C3650		QEKJ1CM-476	E CAPACITOR 47μF,16V
C3652		NDC21HJ-222X	CAPACITOR 0.0022μF,50V
C3655		NDC21HJ-222X	CAPACITOR 0.0022μF,50V
C3656		NCB21HJ-103X	CAPACITOR 0.01μF,50V
C3657		QEKJ1CM-476	E CAPACITOR 47μF,16V
C3658		NDC21HJ-102X	CAPACITOR 0.001μF,50V
C3659		NCB21HJ-103X	CAPACITOR 0.01μF,50V
C3660		NDC21HJ-222X	CAPACITOR 0.0022μF,50V
C3661		NDC21HJ-101X	CAPACITOR 100pF,50V
C3662		QEKJ1HM-105	E CAPACITOR 1μF,50V
C3663		NCB21HJ-103X	CAPACITOR,S9700MS 0.01μF,50V
C3665		NCB21HJ-272X	CAPACITOR,S9700MS 0.0027μF,50V
L3501		QQL29BJ-101Z	COIL 100μH
L3502		QQL29BJ-101Z	COIL 100μH
L3503		QQL29BJ-101Z	COIL 100μH
L3504		QQL29BJ-331Z	COIL 330μH
L3505		QQL29BJ-101Z	COIL,S9700MS 100μH
L3506		QQL29BJ-101Z	COIL 100μH
L3507		QQL29BJ-101Z	COIL 100μH
L3508		QQL29BJ-101Z	COIL 100μH
L3509		QQL29BJ-101Z	COIL,S9700MS 100μH
L3513		QQR0660-001	BLOCK COIL,SECAM DECODER 12μH
L3516		QQL29BJ-101Z	COIL 100μH
X3501		QAX0346-001Z	CRYSTAL RESONATOR,S9700MS
X3502		QAX0344-001Z	CRYSTAL RESONATOR,S9700MS
X3503		QAX0345-001Z	CRYSTAL RESONATOR
FL3501		PELN1223	EQUALIZER
FL3502		QQR0662-001	EQUALIZER
FL3503		QQR0661-001	EQUALIZER
FL3505		PELN1207	LOW PASS FILTER
FL3506		PELN1205	LC TRAP
SD1		LP20275-001B	SHIELD FRAME
OT1		PU59915-105	#500SPACER0.01,X3501,S9700MS
OT2		PU59915-105	#500SPACER0.01,X3502,S9700MS
OT3		PU59915-105	#500SPACER0.01,X3503

#	△ REF No.	PART No.	PART NAME, DESCRIPTION
CN3501		QGF1208F1-04	FPC CONNECTOR,(7-10)MAIN,S8700MS
		QGF1208F1-10	FPC CONNECTOR,(11-20)MAIN,S9700MS
CN3502		QGF1208F1-09	FPC CONNECTOR,(1-9)S-SUB

SECAM BOARD ASSEMBLY <88>

PW1	LPA10069-01A	SECAM BOARD ASSY
IC301	LA7358	IC
Q301	2SB1218A/QR/-X	TRANSISTOR
	or 2PA1576/R/-X	TRANSISTOR
	or 2SA1576A/QR/-X	TRANSISTOR
Q302	UN511E	TRANSISTOR
	or RN2309	TRANSISTOR
	or DTA144WU	TRANSISTOR
R301	NRSA02J-273X	MG RESISTOR 27kΩ,1/10W
R302	NRSA02J-124X	MG RESISTOR 120kΩ,1/10W
R303	NRSA02J-273X	MG RESISTOR 27kΩ,1/10W
R304	NRSA02J-682X	MG RESISTOR 6.8kΩ,1/10W
R305	NRSA02J-473X	MG RESISTOR 47kΩ,1/10W
R306	NRSA02J-273X	MG RESISTOR 27kΩ,1/10W
R307	NRSA02J-222X	MG RESISTOR 2.2kΩ,1/10W
R308	NRSA02J-222X	MG RESISTOR 2.2kΩ,1/10W
R309	NRSA02J-0R0X	MG RESISTOR 0Ω,1/10W
R310	NRSA02J-223X	MG RESISTOR 22kΩ,1/10W
R311	NRSA02J-332X	MG RESISTOR 3.3kΩ,1/10W
R312	NRSA02J-272X	MG RESISTOR 2.7kΩ,1/10W
R313	NRSA02J-223X	MG RESISTOR 22kΩ,1/10W
R314	NRVA02D-243X	CMF RESISTOR 24kΩ,1/10W
R315	NRSA02J-564X	MG RESISTOR 560kΩ,1/10W
R316	NRSA02J-124X	MG RESISTOR 120kΩ,1/10W
R329	NRSA02J-0R0X	MG RESISTOR 0Ω,1/10W
C301	NDC21HJ-151X	CAPACITOR 150pF,50V
C302	NCB21AK-105X	CAPACITOR 1μF,10V
C303	NCB21HK-682X	CAPACITOR 0.0068μF,50V
C304	NCB21HK-682X	CAPACITOR 0.0068μF,50V
C305	NCB21HK-103X	CAPACITOR 0.01μF,50V
C306	NCB21AK-105X	CAPACITOR 1μF,10V
C307	NDC21HJ-151X	CAPACITOR 150pF,50V
C308	NCB21HK-103X	CAPACITOR 0.01μF,50V
C309	NCB21EK-104X	CAPACITOR 0.1μF,25V
C310	NCB21HK-103X	CAPACITOR 0.01μF,50V
C311	NCB21HK-103X	CAPACITOR 0.01μF,50V
C312	NCB21HK-102X	CAPACITOR 0.001μF,50V
C313	NCB21CK-474X	CAPACITOR 0.47μF,16V
C315	NCB21AK-105X	CAPACITOR 1μF,10V
C316	NCB21HK-103X	CAPACITOR 0.01μF,50V
C317	NDC21HJ-681X	CAPACITOR 680pF,50V
C318	NCB21EK-223X	CAPACITOR 0.022μF,25V
C319	NCB21AK-105X	CAPACITOR 1μF,10V
C320	NCB21HK-103X	CAPACITOR 0.01μF,50V
C321	NDC21HG-301X	CAPACITOR 300pF,50V
C322	NCB21CK-474X	CAPACITOR 0.47μF,16V
L302	QQL231J-6R8Y	COIL 6.8μH
L303	QQL231J-270Y	COIL 27μH
OT1	PU60010	SPACER
CN301	QGG2509M1-05	HEADER PIN
CN302	QGG2509M1-06	HEADER PIN